



V219

# PRODUCT CATALOGUE

LUBRICATION EQUIPMENT

AUTOMOTIVE • PETROLEUM • INDUSTRIAL

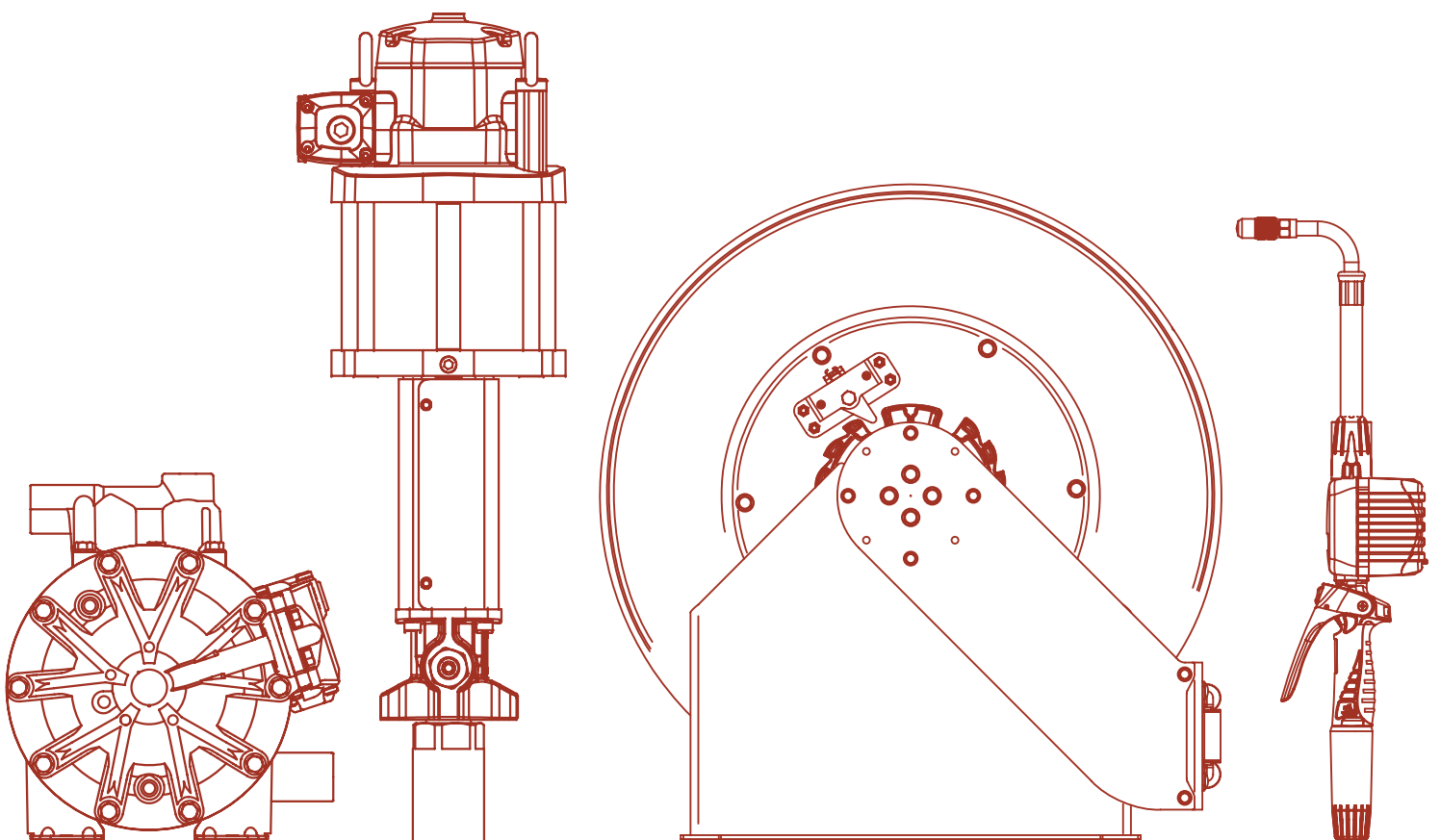

## 04 HOSE REELS

HOSE REEL MOUNTING RECOMMENDATIONS . . . . .	64
RM-12 DOUBLE PEDESTAL DOUBLE ARM HOSE REELS . . . . .	65
RM-12S SINGLE ARM ALUMINIUM HOSE REELS . . . . .	66
RM-12CLX ENCLOSED HOSE REELS . . . . .	67
RM-12CL INDIVIDUALLY ENCLOSED HOSE REELS . . . . .	68
RM-12L HEAVY DUTY HOSE REELS . . . . .	69
RM-34 HEAVY DUTY HOSE REELS . . . . .	70
RM-100 HEAVY DUTY LARGE CAPACITY HOSE REELS . . . . .	71
RM-150 HEAVY DUTY LARGE DELIVERY HOSE REELS . . . . .	72
COMPACT REELS FOR AIR AND CABLE . . . . .	73
HOSE REEL ACCESSORIES . . . . .	74





SAMOA hose reels, used around the world, are designed to be premium quality fluid reels. Hose reels are adaptable to wall, floor or ceiling mounting, individually or in banks. They are available for high, medium and low pressure applications. Different hose capacities for maximum flexibility in selecting a hose reel assembly to match any specific need. SAMOA hose reels are designed with non-restrictive fluid passages and the right hose diameter for each application to provide the quickest material delivery.

SAMOA hose reels are spring-powered and self-retracting; a latch locks the reel at desired length and a slight pull releases latch, and the hose retracts smoothly onto reel. Hose guide arm can be placed in different positions to accommodate any method of mounting and allow hose to be automatically removed or retracted without kinking, reducing strain on hose and minimizing the possibility of hose damage.

## REEL MASTER®

COMPRESSED AIR • WATER • DIESEL • LUBRICANTS • ANTIFREEZE • WINDSHIELD WASH • GREASE • AdBlue®

### ADVANTAGES OF THE USE OF HOSE REELS

- Increased productivity.
- Reduced wear and increased life of hoses.
- Simple hose handling and storage.
- Lower risk of accidents as hose reels keep hoses out of the floor.
- Work environment improvement.

### ALL SAMOA REELS HAVE

- Superior power spring life. Special fatigue resistant steel spring guarantees long life and trouble free operation and provides even tension at every point, when pulling or retracting hose.
- Heavy duty ratchet, with large effective radial latching area for an easier and user-friendly operation.
- Metal arms, enclosures, base and spool are epoxy powder coated for increased wear resistance.
- SAMOA only uses high quality hoses, specially formulated for use in hose reels.

### HOSE SPECIFICATIONS

**Compressed air, low pressure water** - SBR black rubber with single textile reinforcement braid and zinc plated fittings.

**Oil, antifreeze solutions** - NBR black rubber with single steel reinforcement steel braid and zinc plated fittings.

**High pressure grease** - NBR black rubber with single steel reinforcement high density braid and zinc plated fittings.

**Windshield wash solutions, AdBlue®/DEF** - EPDM hose with single textile reinforcement braid and stainless steel fittings.

**High pressure water:** SBR black rubber with single steel reinforcement braid and zinc plated fittings.

### HOSE REEL MOUNTING RECOMMENDATIONS

- Install reels as high as possible when mounted to wall or ceiling. Minimum height from the lowest reel point to the floor must be 2,5 m (8').
- Always avoid lateral pulls of hose. In case they cannot be avoided, and for single reel installations, use a pivoting bracket.
- Hose reels allow positioning the hose outlet in different positions. Always choose the one that allows a tangential unwind of the hose.
- A shut off valve shall be installed at the inlet hose to allow the isolation of each reel for service purposes.

# RM-12 DOUBLE PEDESTAL DOUBLE ARM HOSE REELS



10 METERS MAXIMUM HOSE CAPACITY

501 200

## FLUIDS HANDLED

- Air.
- Water.
- Antifreeze Solutions.
- Synthetic and Mineral Oils.
- Grease.

## MARKETS / APPLICATIONS

- Car and truck dealers.
- Service shops.
- General manufacturing.
- Service stations.
- Quick lubes.

## MOUNTING

- Floor.
- Wall.
- Ceiling.
- Tank.

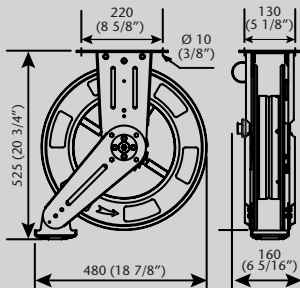

Dimensions mm (inches)

Full metal hose reels, can handle up to 10 m x 1/2" hose.



- Fatigue resistant steel spring for years of durable performance and even load when pulling and recoiling the hose.
- Full metal double pedestal arm construction, epoxy powder coated for increased wear resistance.
- Forged brass shaft ensures a leak free operation.
- Hose reels with hose include 0,8 m inlet hose.

04

HOSE REELS

PART No.	BARE REEL	HOSE IN Ø	HOSE LENGTH	CONNECTING HOSE INLET	DELIVERY HOSE OUTLET	PRESSURE RATING	WEIGHT (With hose)
<b>AIR / WATER / ANTIFREEZE SOLUTIONS</b>							
501 100	501 198	3/8"	10 m	1/2" BSP (M)	1/4" BSPT (M)	15 bar	17,9 kg
<b>MINERAL AND SYNTHETIC LUBRICANTS</b>							
501 200	501 298	1/2"	10 m	1/2" BSP (M)	1/2" BSP (M)	160 bar	20 kg
<b>GREASE</b>							
501 300	501 398	1/4"	10 m	1/2" BSP (M)	1/4" BSP (M)	350 bar	19,2 kg

Bare reels include hose stopper, swivel and connection adaptors.



Reel with arms in ceiling mounting position.

506 202

15 METERS MAXIMUM HOSE CAPACITY

Aluminium base and arms with composite spool hose reels, can handle up to 15 m x 1/2" hose.



### FLUIDS HANDLED

- Air.
- Water.
- Antifreeze and Windshield Wash Solutions.
- High Pressure Hot Water.
- Synthetic and Mineral Oils.
- AdBlue® / DEF.
- Grease.

### MARKETS / APPLICATIONS

- Car and truck dealers.
- Service shops.
- Fleets.
- General manufacturing.
- Service stations.
- Lube trucks.
- Quick lubes.

### MOUNTING

- Floor.
- Wall.
- Ceiling.
- Tank.

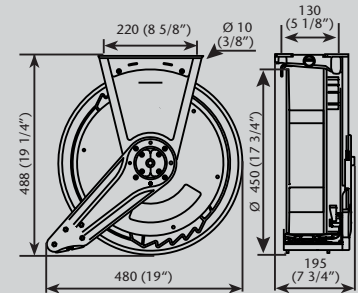

Dimensions mm (inches)

- Aluminium base and guide arm provide the rigidity to withstand the most demanding applications while offering a reduced weight for easy installation.
- Fatigue resistant steel spring for years of durable performance and even load when pulling and recoiling the hose.
- Full port shaft and swivel for no restrictions.
- Spool mounted on two permanent lubricated and sealed ball bearings to reduce torque load on spring for smooth retraction and longer life.
- Large effective radial latching area for easier operation.
- Six roller guide outlet prevents hose pinching and reduces friction.
- Hose guide arm can be placed in different positions to accommodate any method of mounting.
- Hose reels with hose include 0,8 m inlet hose.



Reel with arms in ceiling mounting position.

PART No.	BARE REEL	HOSE IN Ø	HOSE LENGTH	CONNECTING HOSE INLET	DELIVERY HOSE OUTLET	PRESSURE RATING	WEIGHT (With hose)
<b>AIR / WATER / ANTIFREEZE SOLUTIONS</b>							
<b>506 101</b>	<b>506 910</b>	3/8"	10 m	3/8" BSP (M)	3/8" BSP (M)	15 bar	12,1 kg
<b>506 121</b>	<b>506 912</b>	3/8"	15 m	3/8" BSP (M)	3/8" BSP (M)	15 bar	14,2 kg
<b>506 122</b>	<b>506 919</b>	1/2"	15 m	1/2" BSP (M)	1/2" BSP (M)	15 bar	14,9 kg
<b>WINDSHIELD AND WINDSHIELD WASH SOLUTIONS / AdBlue® - DEF / DETERGENTS</b>							
<b>506 762</b>	<b>506 976</b>	1/2"	10 m	1/2" BSP (M)	1/2" BSP (M)	20 bar	13 kg
<b>506 782</b>	<b>506 982</b>	1/2"	15 m	1/2" BSP (M)	1/2" BSP (M)	20 bar	15,5 kg
<b>SYNTHETIC AND MINERAL OILS</b>							
<b>506 202</b>	<b>506 920</b>	1/2"	10 m	1/2" BSP (M)	1/2" BSP (M)	160 bar	12,6 kg
<b>506 222</b>	<b>506 922</b>	1/2"	15 m	1/2" BSP (M)	1/2" BSP (M)	160 bar	14,9 kg
<b>506 212*</b>	<b>506 921</b>	1/2"	15 + 3 m	1/2" BSP (M)	1/2" BSP (M)	160 bar	15,7 kg
<b>WASTE OIL SUCTION</b>							
<b>506 503</b>	<b>506 950</b>	5/8"	6 m	1/2" BSP (M)	1/2" BSP (M)	Vacuum	13,3 kg
<b>GREASE AND HYDRAULIC FLUID</b>							
<b>506 300</b>	<b>506 930</b>	1/4"	10 m	1/4" BSP (M)	1/4" BSP (M)	350 bar	12,4 kg
<b>506 301</b>	<b>506 934</b>	3/8"	10 m	3/8" BSP (M)	1/4" BSP (M)	280 bar	12,9 kg
<b>506 321</b>	<b>506 936</b>	3/8"	15 m	3/8" BSP (M)	1/4" BSP (M)	280 bar	16 kg
<b>506 311*</b>	<b>506 935</b>	3/8"	15 + 3 m	3/8" BSP (M)	1/4" BSP (M)	280 bar	17 kg
<b>HIGH PRESSURE HOT WATER (UP TO 100 °C)</b>							
<b>506 421</b>	<b>506 942</b>	3/8"	15 m	3/8" BSP (M)	1/4" BSP (M)	170 bar	15,1 kg

\*15 + 3 m models shall be used in installations allowing a minimum of 3 m of hose hanging from the reel.

15 METERS MAXIMUM HOSE CAPACITY

502 252

### FLUIDS HANDLED

- Air.
- Water.
- Antifreeze and Windshield Wash Solutions.
- Synthetic and Mineral Oils.
- Grease.

### MARKETS / APPLICATIONS

- Car and truck dealers
- Service shops
- Fleets
- General manufacturing
- Service stations
- Lube trucks
- Quick lubes.

### MOUNTING

- Floor.
- Wall.
- Ceiling.
- Tank.

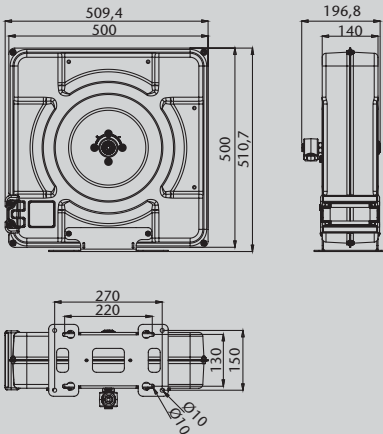

Dimensions mm (inches)

Aluminium enclosure with composite spool hose reels, can handle up to 15 m x 1/2" hose.



04

HOSE REELS

- Totally enclosed reel in steel plate finished in polyester resin.
- Positionable mounting bracket in steel plate with 2 drill patterns: 220 x 130 mm and 270 x 150 mm.
- Ratchet system in polymer to reduce noise.
- Large service panel allows hose reel maintenance without dismantling it.
- Wide hose outlet aids rolling, reduces piling up and premature wear of the hose.
- Fatigue resistant steel spring for years of durable performance and even load when pulling and recoiling the hose.
- Spool mounted on two permanent lubricated and sealed ball bearings to reduce torque load on spring for smooth retraction and longer life..
- Hose reels with hose include 0,8 m inlet hose.

PART No.	BARE REEL	HOSE IN Ø	HOSE LENGTH	CONNECTING HOSE INLET	DELIVERY HOSE OUTLET	PRESSURE RATING	WEIGHT (WITH HOSE)
<b>AIR / WATER</b>							
502 151	502 159	3/8"	10 m	3/8" BSP (M)	3/8" BSP (M)	15 bar	18,7 Kg
502 156	502 159	3/8"	15 m	3/8" BSP (M)	3/8" BSP (M)	15 bar	19,7 Kg
502 157	502 159	1/2"	15 m	1/2" BSP (M)	1/2" BSP (M)	15 bar	20,6 Kg
<b>OIL</b>							
502 252	502 259	1/2"	10 m	1/2" BSP (M)	1/2" BSP (M)	20 bar	20,9 Kg
502 257	502 259	1/2"	15 m	1/2" BSP (M)	1/2" BSP (M)	20 bar	23 Kg
<b>GRAISSE AND HYDRAULIC FLUIDS</b>							
502 350	502 359	1/4"	10 m	1/4" BSP(M)	1/4" BSP(M)	160 bar	20,4 Kg
502 351	502 359	3/8"	10 m	3/8" BSP(M)	1/4" BSP(M)	160 bar	21,9 Kg
502 356	502 359	3/8"	15 m	3/8" BSP(M)	1/4" BSP(M)	160 bar	24,45 Kg



Reel with arms in ceiling mounting position.

507 202

15 METERS MAXIMUM HOSE CAPACITY

Aluminium enclosure with composite spool hose reels, can handle up to 15 m x 1/2" hose.



### FLUIDS HANDLED

- Air.
- Water.
- Antifreeze and Windshield Wash Solutions.
- High Pressure Hot Water.
- Synthetic and Mineral Oils.
- AdBlue® / DEF.
- Grease.

### MARKETS / APPLICATIONS

- Car and truck dealers.
- Service shops.
- Fleets.
- General manufacturing.
- Service stations.
- Lube trucks.
- Quick lubes.

### MOUNTING

- Floor.
- Wall.
- Ceiling.
- Tank.

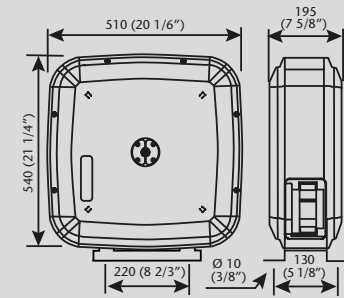

Dimensions mm (inches)

- Corrosion resistant aluminium enclosure form a very rigid and stable structure, with light weight and attractive design.
- Fatigue resistant steel spring for years of durable performance and even load when pulling and recoiling the hose.
- Full port shaft and swivel for no restrictions.
- Spool mounted on two permanent lubricated and sealed ball bearings to reduce torque load on spring for smooth retraction and longer life.
- Large effective radial latching area for easier operation.
- Positionable mounting brackets to accommodate any method of mounting.
- Two large lateral service windows facilitate common maintenance operations.
- Hose reels with hose include 0,8 m inlet hose.



Reel with arms in ceiling mounting position.

PART No.	BARE REEL	HOSE IN Ø	HOSE LENGTH	CONNECTING HOSE INLET	DELIVERY HOSE OUTLET	PRESSURE RATING	WEIGHT (With hose)
<b>AIR / WATER / ANTIFREEZE SOLUTIONS</b>							
<b>507 101</b>	<b>507 910</b>	3/8"	10 m	3/8" BSP (M)	3/8" BSP (M)	15 bar	18,4 kg
<b>507 121</b>	<b>507 912</b>	3/8"	15 m	3/8" BSP (M)	3/8" BSP (M)	15 bar	20,7 kg
<b>507122</b>	<b>507 919</b>	1/2"	15 m	1/2" BSP (M)	1/2" BSP (M)	15 bar	21,4 kg
<b>WINDSHIELD AND WINDSHIELD WASH SOLUTIONS / AdBlue® - DEF / DETERGENTS</b>							
<b>507 762</b>	<b>507 976</b>	1/2"	10 m	1/2" BSP (M)	1/2" BSP (M)	20 bar	19 kg
<b>507 782</b>	<b>507 978</b>	1/2"	15 m	1/2" BSP (M)	1/2" BSP (M)	20 bar	20,5 kg
<b>SYNTHETIC AND MINERAL OILS</b>							
<b>507 202</b>	<b>507 920</b>	1/2"	10 m	1/2" BSP (M)	1/2" BSP (M)	160 bar	18,9 kg
<b>507 222</b>	<b>507 922</b>	1/2"	15 m	1/2" BSP (M)	1/2" BSP (M)	160 bar	21,4 kg
<b>507 212*</b>	<b>507 921</b>	1/2"	15 + 3 m	1/2" BSP (M)	1/2" BSP (M)	160 bar	22,2 kg
<b>WASTE OIL SUCTION</b>							
<b>507 503</b>	<b>507 950</b>	5/8"	6 m	1/2" BSP (M)	1/2" BSP (M)	Vacuum	19,1 kg
<b>GREASE AND HYDRAULIC FLUID</b>							
<b>507 300</b>	<b>507 930</b>	1/4"	10 m	1/4" BSP (M)	1/4" BSP (M)	350 bar	18,8 kg
<b>507 301</b>	<b>507 934</b>	3/8"	10 m	3/8" BSP (M)	1/4" BSP (M)	280 bar	19,5 kg
<b>507 321</b>	<b>507 936</b>	3/8"	15 m	3/8" BSP (M)	1/4" BSP (M)	280 bar	22,6 kg
<b>507 311*</b>	<b>507 935</b>	3/8"	15 + 3 m	3/8" BSP (M)	1/4" BSP (M)	280 bar	23,6 kg
<b>HIGH PRESSURE HOT WATER (UP TO 100 °C)</b>							
<b>507 421</b>	<b>507 942</b>	3/8"	15 m	3/8" BSP (M)	1/4" BSP (M)	170 bar	22,2 kg

# RM-12L HEAVY DUTY HOSE REELS



15 METERS MAXIMUM HOSE CAPACITY

504 250

### FLUIDS HANDLED

- Air.
- Water.
- Antifreeze and Windshield Wash Solutions.
- High Pressure Hot Water.
- Synthetic and Mineral Oils.
- Grease.

### MARKETS / APPLICATIONS

- Car and truck dealers.
- Service shops.
- Fleets.
- Lube trucks.
- Mining and construction.
- Railroad and mass transit.
- General manufacturing.

### MOUNTING

- Floor.
- Wall.
- Ceiling.
- Tank.

**Full metal Intensive Duty double pedestal hose reels, with hose capacity up to 15 m x 1/2" hose.**

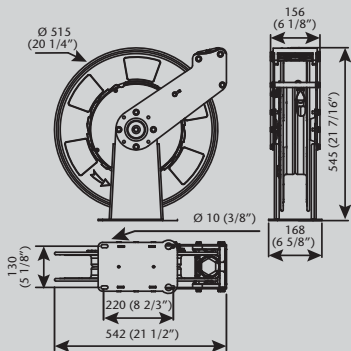

Dimensions mm (inches)

- Very tough construction able to stand regular use and abuse in Intensive Duty applications.
- Fatigue resistant steel spring for years of durable performance and even load when pulling and recoiling the hose.
- Full port shaft and swivel for no restrictions.
- Spool mounted on two permanent lubricated and sealed ball bearings to reduce torque load on spring for smooth retraction and longer life.
- Large effective radial latching area for easier operation.
- Hose guide arm can be placed in different positions to accommodate any method of mounting.
- Narrow footprint allows accommodating more reels on the same surface.
- Hose reels with hose include 0,8 m inlet hose.

PART No.	BARE REEL	HOSE IN Ø	HOSE LENGTH	CONNECTING HOSE INLET	DELIVERY HOSE OUTLET	PRESSURE RATING	WEIGHT (With hose)
<b>AIR / WATER / ANTIFREEZE SOLUTIONS</b>							
504 150	504 159	1/2"	15 m	1/2" BSP (M)	1/2" BSP (M)	15 bar	24 kg
<b>SYNTHETIC AND MINERAL OILS</b>							
504 250	504 259	1/2"	15 m	1/2" BSP (M)	1/2" BSP (M)	160 bar	24 kg
<b>GREASE AND HYDRAULIC FLUID</b>							
504 350	504 359.001	1/4"	15 m	1/4" BSP (M)	1/4" BSP (M)	350 bar	27,5 kg
504 351	504 359	3/8"	15 m	3/8" BSP (M)	1/4" BSP (M)	280 bar	26 kg
<b>HIGH PRESSURE HOT WATER (UP TO 100 °C)</b>							
504 450	504 459	3/8"	15 m	3/8" BSP (M)	1/4" BSP (M)	170 bar	26 kg



Reel with arms in ceiling mounting position.

\*15 + 3 m models shall be need in installations allowing a minimum of 3 m of hose hanging from the reel.



505 224

15 AND 20 METERS MAXIMUM HOSE CAPACITY

**Full metal, Intensive Duty double pedestal hose reels with hose capacity up to 15 m x 3/4" and 20 m x 1/2" hose.**



### FLUIDS HANDLED

- Air.
- Water.
- Antifreeze and windshield wash solutions.
- Synthetic and mineral oils.
- AdBlue® / DEF.
- Waste Oil Evacuation.
- Diesel.
- Grease.

### MARKETS / APPLICATIONS

- Truck dealers.
- Service shops.
- Fleets.
- Lube trucks.
- Mining and construction.
- Railroad and mass transit.
- General manufacturing.

### MOUNTING

- Floor.
- Wall.
- Ceiling.
- Tank.

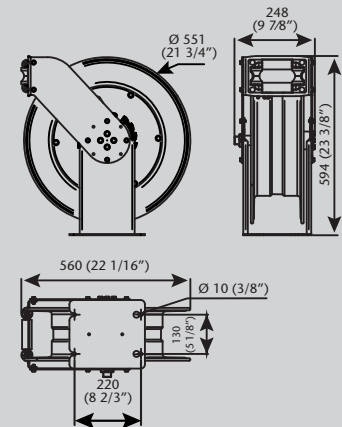

Dimensions mm (inches)

- Very tough construction able to stand regular use and abuse in Intensive Duty applications.
- Fatigue resistant steel spring for years of durable performance and even load when pulling and recoiling the hose.
- Full port shaft and swivel for no restrictions.
- Spool mounted on two permanent lubricated and sealed ball bearings to reduce torque load on spring for smooth retraction and longer life.
- Large effective radial latching area for easier operation.
- Hose guide arm can be placed in different positions to accommodate any method of mounting.
- Narrow footprint allows accommodating more reels on the same surface.
- Hose reels with hose include 0,8 m inlet hose.

PART No.	BARE REEL	HOSE IN Ø	HOSE LENGTH	CONNECTING HOSE INLET	DELIVERY HOSE OUTLET	PRESSURE RATING	WEIGHT (With hose)
<b>AIR / WATER / ANTIFREEZE SOLUTIONS / DIESEL / LUBRICANTS</b>							
505 232	505 932	1/2"	20 m	1/2" BSP (M)	1/2" BSP (M)	160 bar	36 kg
505 224	505 924	3/4"	15 m	3/4" BSP (M)	3/4" BSP (M)	105 bar	38 kg
<b>ADBLUE® - DEF / WINDSHIELD WASH SOLUTIONS / WASHING SOLUTIONS</b>							
505 524	505 529	3/4"	15 m	3/4" BSP (F)	3/4" BSP (F)	20 bar	39 kg
<b>GREASE AND HYDRAULIC FLUID</b>							
505 332	505 339	1/2"	20 m	1/2" BSP (M)	1/2" BSP (M)	275 bar	39 kg

# RM-100 HEAVY DUTY LARGE CAPACITY HOSE REELS



15, 20, 25 AND 30 METERS MAXIMUM HOSE CAPACITY

508 225

### FLUIDS HANDLED

- Air.
- Water.
- Antifreeze solutions.
- Synthetic and mineral oils.
- Waste Oil Evacuation.
- Diesel.

### MARKETS / APPLICATIONS

- Fleets.
- Lube trucks.
- Mining and construction.
- Railroad and mass transit.
- General manufacturing.

### MOUNTING

- Floor.
- Tank.

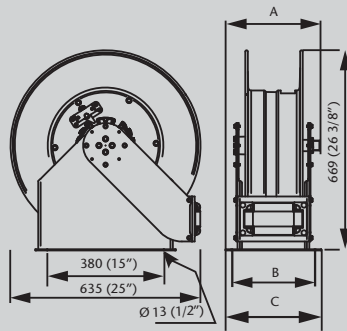

Dimensions mm (inches)

DIMENSIONS mm (inches)		
PART No.	508 925	508 942 508 944
A	315 (12 3/8")	349 (13 3/4")
B	290 (11 3/8")	320 (12 5/16")
C	320 (12 5/16")	353 (13 15/16")

**Full metal, Intensive Duty, double pedestal hose reels, with hose capacity up to 15 m x 1", 20 m or 25 m x 3/4" hose and 30 m x 1/2" hose.**



04

HOSE REELS

- Very tough construction large capacity reels, able to stand regular use and abuse in Intensive Duty applications.
- Fatigue resistant steel spring for years of durable performance and even load when pulling and recoiling the hose.
- Full port shaft and swivel for no restrictions.
- Spool mounted on two permanent lubricated and sealed ball bearings to reduce torque load on spring for smooth retraction and longer life.
- Large effective radial latching area for easier operation.
- Hose guide arm can be placed in different positions to accommodate any method of mounting.
- Narrow footprint allows accommodating more reels on the same surface.
- Reels with longer hose capacity include a dual spring for effective hose retraction.
- Hose reels with hose include 0,8 m inlet hose.

PART No.	BARE REEL	HOSE IN Ø	HOSE LENGTH	CONNECTING HOSE INLET	DELIVERY HOSE OUTLET	PRESSURE RATING	WEIGHT (With hose)
<b>AIR / WATER / ANTIFREEZE SOLUTIONS / DIESEL / LUBRICANTS / WASTE OIL EVACUATION</b>							
508 225	508 925	1"	15 m	1" BSP (M)	1" BSP (M)	90 bar	56 kg
508 234	508 944	3/4"	20 m	3/4" BSP (M)	3/4" BSP (M)	90 bar	55 kg
508 244	508 944	3/4"	25 m	3/4" BSP (M)	3/4" BSP (M)	90 bar	57 kg
508 252	508 942	1/2"	30 m	1" BSP (M)	1/2" BSP (M)	90 bar	55 kg

508 810

15 METERS MAXIMUM HOSE CAPACITY

Full metal, Intensive Duty, hose reel with hose capacity up to 15 m x 1-1/2" hose.



### FLUIDS HANDLED

- Water.
- Diesel.

### MARKETS / APPLICATIONS

- Fleets.
- Lube trucks.
- Mining and construction.
- Railroad and mass transit.
- General manufacturing.

### MOUNTING

- Floor.
- Tank.

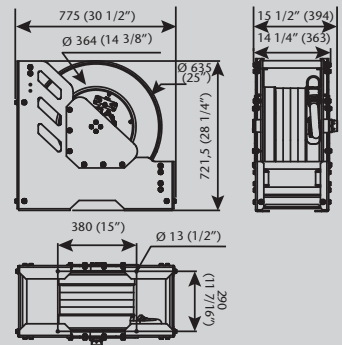

Dimensions mm (inches)

- Very tough construction large delivery reels, able to stand regular use and abuse in Intensive Duty applications.
- Fatigue resistant steel spring for years of durable performance and even load when pulling and recoiling the hose.
- Full port shaft and swivel for no restrictions.
- Spool mounted on two permanent lubricated and sealed ball bearings to reduce torque load on spring for smooth retraction and longer life.
- Large effective radial latching area for easier operation.
- Hose guide arm can be placed in two different positions to accommodate any method of mounting.
- Narrow footprint allows accommodating more reels on the same surface.

PART No.	BARE REEL	HOSE IN Ø	HOSE LENGTH	CONNECTING HOSE INLET	DELIVERY HOSE OUTLET	PRESSURE RATING	WEIGHT (With hose)
<b>WATER / DIESEL</b>							
<b>508 810</b>	<b>508 890</b>	1-1/2"	15 m	1-1/2" BSP (F)	1-1/2" BSP (F)	20 bar	87 kg

## COMPACT REELS FOR AIR AND CABLE

### COMPACT REELS FOR AIR - RM-38 SERIES

500 115

Compact enclosed reels for compressed air, manufactured in steel. All reels include pivoting wall bracket for an easy and convenient installation. Reels are supplied with PVC hose and they have a maximum working pressure of 15 bar (285 psi).

#### 500 115 Compact hose reel for air 15 m x 8 mm hose

Compact reel for air with 15 m x 8 mm hose. Includes 0.8 m inlet hose and pivoting bracket. Inlet thread: 3/8" BSP (M). Outlet thread: 1/4" BSP (M).

#### 500 116 Compact hose reel for air 12 m x 10 mm hose

Compact reel for air with 12 m x 10 mm hose. Includes 0.8 m inlet hose and pivoting bracket. Inlet thread: 3/8" BSP (M). Outlet thread: 3/8" BSP (M).

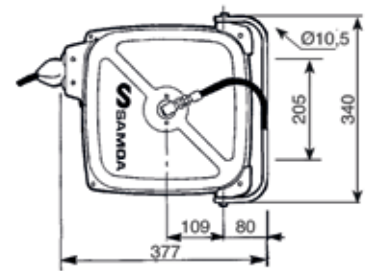

04

HOSE REELS

### CABLE REELS - RM-POWER SERIES

612 400 - 612 100

Compact reels with high resistance thermoplastic enclosure. Compact design, with wide outlet for a comfortable and friction free cable extension. All reels include pivoting bracket, cable specified for each model, and cable overload breaker. For use with 230 V – 50 Hz only.



**612 400 - 230 V, 50 Hz cable reel with 230 V AC to 24 V DC transformer with LED lamp.**  
15 m H05RN-F 2x1 mm<sup>2</sup> cable hose reel. Includes a 230 V AC to 24 V DC transformer and a 900 LUMEN LED light.

#### 612 100 - 230 V, 50 Hz cable reel

Includes 15 m H05VV-F 3x1,5 mm<sup>2</sup> cable, 230 V - 50 Hz. Maximum power: 800 W with the cable coiled and 2.000 W with the cable fully extended because of heat dissipation.

#### 612 200 - 230 V, 50 Hz cable reel with 230 V AC to 24 V DC transformer

Includes 15 m H05VV-F 2x1 mm<sup>2</sup> cable. Maximum power: 60 W Includes a 230 V AC to 24 V DC transformer. For use with an E27 24 V - DC lamp (lamp not included).

#### 612 300 - 230 V, 50 Hz cable reel with 230 V AC to 12 V DC transformer

Includes 15 m H05VV-F 2x1 mm<sup>2</sup> cable. Maximum power: 60 W Includes a 230 V AC to 12 V DC transformer. For use with an E27 12 V - DC lamp (inspection lamp included, bulb not included).

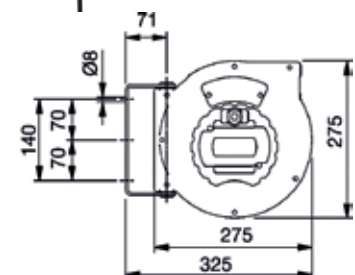

## SINGLE REEL BRACKETS



360 111



360 116



360 119

**360 111 Pivoting wall mount bracket.** Use with RM12S, RM12CL, RM12, RM12L and RM34 Series reels.

**360 116 I-beam mounting bracket. Includes a pair of brackets and hardware.** Eliminates the need to drill column or beam when mounting an individual reel to beam flange. Use with RM12S, RM12CL, RM12 and RM12L series reels.

**360 135 Bracket for mounting a RM12S, RM12CL, RM12 or RM12L Series reel to a drum trolley (432 000).**

**360 113 One reel bracket for 432 814 trolley** Use with RM12S, RM12CL, RM12, and RM12L reels.

**360 119 Fast mount bracket. Facilitates mounting a reel to a wall or ceiling.** Use with RM12S, RM12CL, RM12, RM12L and RM34 reels.

## MULTIPLE REEL BRACKETS

Hose reel mounting channels for use with RM12S, RM12CL, RM12, and RM12L series hose reels in a bank. Channels are pre-drilled to allow individual mounting of reel. Nuts, screws and washers included.

360 117

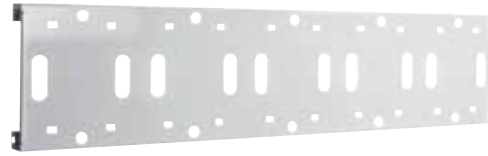

**360 114 Holds up to two reels.**

Dimensions: 550 x 308 x 75 mm.

**360 115 Holds up to three reels.**

Dimensions: 825 x 308 x 75 mm. This bracket can also hold 2 x RM34 Series reels.

**360 117 Holds up to five reels.**

Dimensions: 1.375 x 308 x 75 mm. This bracket can also hold 3 x RM34 Series reels.

## GUN HOLDERS AND DRIP POCKETS

360 127



360 122



360 126



**Part No. 360 122**

Wall mounted drip pocket.

**Part No. 360 126**

Gun holder for hose reels.

**Part No. 360 127**

Wall mount drip pocket and gun holder.

## REEL STANDS

360 161



360 162



**360 161 Two hose reel stand**

For use with any pair of RM-12 hose reels. Height: 2.375 mm.

**360 162 Three hose reel stand**

For use with all RM-12 models, includes drip tray.

Dimensions: 1.200 x 400 x 2.220 mm.

360 163

360 160



FIVE HOSE REEL STAND

SIX HOSE REEL STAND

**360 163 Five hose reel stand**

For use with all RM-12 reel models, includes drip tray. Dimensions: 1.750 x 400 x 2.220 mm.

Very solid construction, allows mounting six RM-12 or RM-34 hose reels depending on models. Two extra reels can be mounted using the optional accessory. Six reel stands include perforated internal side panels and drip tray.

**360 160 Six reel stand**

Narrow model for use with RM-12 reels. Dimensions: 1.543 x 760 x 2.600 mm.

**360 165 Six reel stand**

Wide model for use with RM-12CL and RM-34 reels. Dimensions: 1.972 x 760 x 2.600 mm.

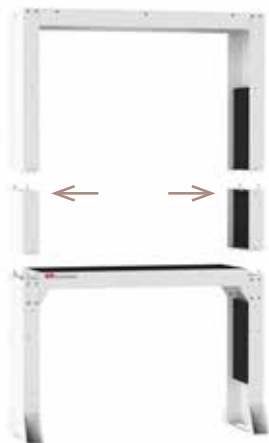

360 164



360 166



SIX HOSE REEL STANDS ACCESSORIES

For use with 360 160 and 360 165 stands as mentioned.

**360 164 Height extension kit**

The kit allows rising 500 mm the stand height. For use with 360 160 and 360 165 stands.

**360 166 Additional bracket for two hose reel**

The additional bracket allows mounting two additional hose reels on one side of a six reel stand 360 160 and 360 165.

**360 168 Additional drip tray**

For use on one side of a six reel stand 360 160 and 360 165 when equipped with the 360 166 additional bracket.

**736 229 Drawers kit**

The kit allows mounting two drawers with lock to the six reel stand 360 160.

