



LEADING THROUGH INNOVATION

PRODUCT CATALOGUE

LUBRICATION EQUIPMENT

AUTOMOTIVE • PETROLEUM • INDUSTRIAL

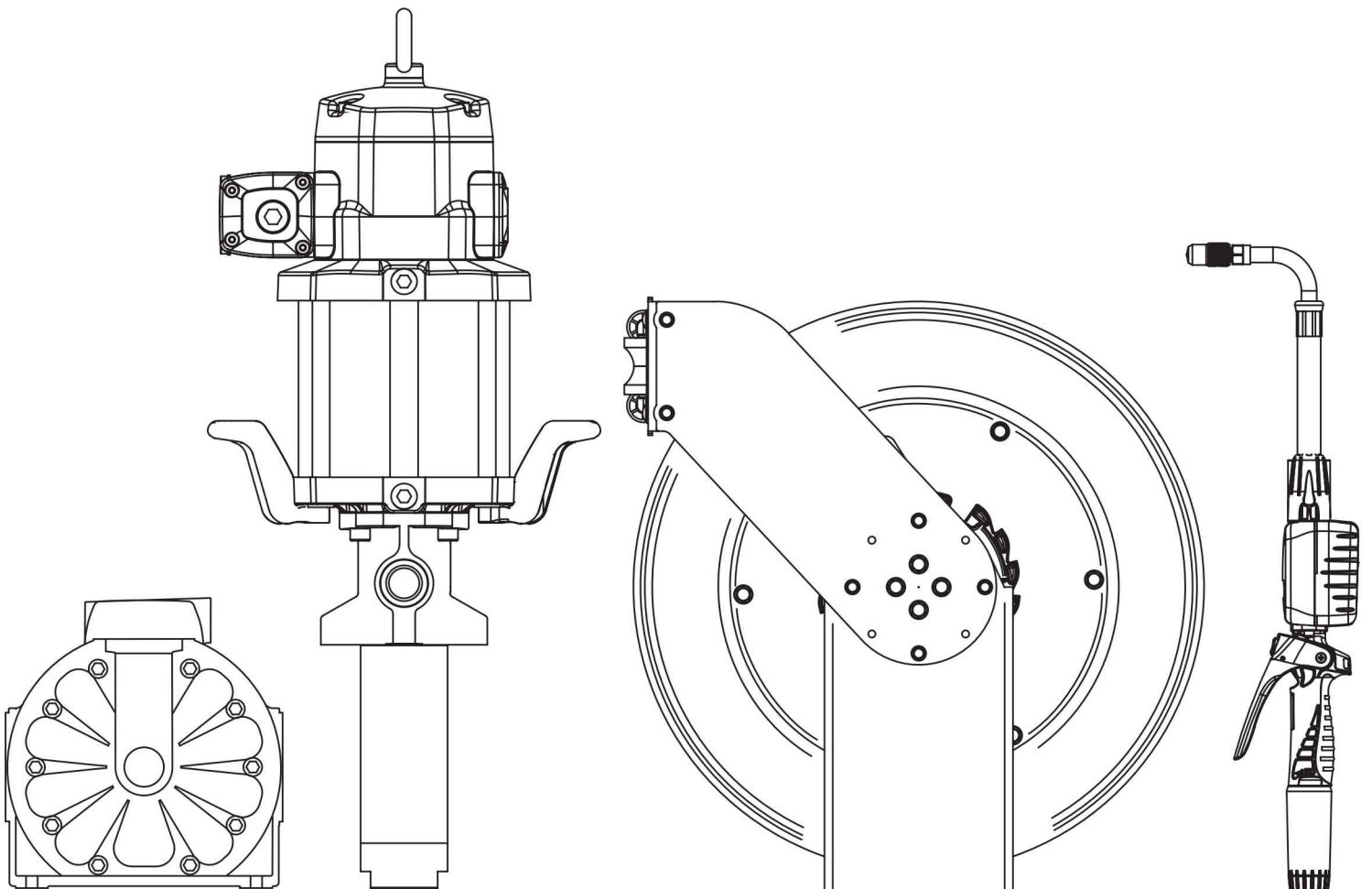

AIR OPERATED GREASE PUMPS	34
PUMPMASTER 3 - 55:1 RATIO GREASE PUMPS	36
PUMPMASTER 3 ACCESSORIES	38
PUMPMASTER 35 - 60:1 RATIO GREASE PUMPS	40
PUMPMASTER 35 ACCESSORIES	42
PUMPMASTER 45 - 25:1 RATIO GREASE PUMP	43
PUMPMASTER 45 - 40:1 RATIO GREASE PUMPS	44
PUMPMASTER 45 - 70:1 RATIO GREASE PUMPS	45
PUMPMASTER 60 - 12:1 RATIO GREASE PUMP	46
PUMPMASTER 60 - 80:1 RATIO GREASE PUMPS	47
PUMPMASTER 45 & 60 INSTALLATION KITS	48
PUMPMASTER 45 & 60 GREASE PUMP KITS	49
PUMPMASTER 35, 45 & 60 GREASE PUMP KITS	50
GREASE PUMP ACCESSORIES	51





AIR OPERATED GREASE PUMPS

SAMOA offers a range of high pressure and high delivery grease pumps to handle a wide variety of applications. This pump offering fits original container sizes, from small pails to drums, totes and speciality built tanks, and covers applications from mobile and portable units to large distribution systems.

SAMOA's grease pumps are designed to provide years of dependable service. The in-line balanced design assures maximum pump efficiency. All Samoa pumps have a double acting design, pumping product on both the upstroke and downstroke. An effective priming piston provides positive pump, even when used with high viscosity or tacky greases. A hardened foot valve minimizes pump damage due to dirt. A corrosion proof air motor design tolerates moisture in compressed air.

PUMP MASTER®

UTILITY PUMP



HEAVY-DUTY



	PUMPMASTER 3 - 55:1	PUMPMASTER 35 - 60:1
PUMP DESCRIPTION	Utility high pressure	Heavy-Duty high pressure
SIMULTANEOUS OPERATION OUTLETS	1 No reels - mobile units	3
MAX. LINE LENGTH	15 m - 50'	75 m - 250'
APPLICATION	Agriculture Service shops Light Industrial	Heavy-Duty service shops Fleets Lube trucks Mining and construction In-plant Railroad and mass transit

Maximum line length and number of simultaneous dispense points also depends on the line diameter, fluid viscosity and required delivery



HEAVY-DUTY



PUMPMASTER 45 - 25:1	PUMPMASTER 45 - 40:1	PUMPMASTER 45 - 70:1	PUMPMASTER 60 - 12:1	PUMPMASTER 60 - 80:1
Heavy-Duty pressure transfer	Heavy-Duty high flow	Heavy-Duty high pressure	Heavy-Duty volume transfer	Heavy-Duty high performance
1 or more	4 or more	4 or more	1 High volume transfer	4 or more
75 m - 250'	125 m - 400'	175 m - 600'	50 m - 175'	250 m - 800'
Moderate pressure transfer Lube trucks Mining and construction In-plant	Heavy-Duty service shops Fleets Lube trucks Mining and construction Railroad and mass transit In-plant Marine	Heavy-Duty service shops Fleets Lube trucks Mining and construction Railroad and mass transit In-plant Marine	Low pressure, high volume transfer Mining and construction In-plant Railroad and mass transit	Fleets Lube trucks Mining and construction Railroad and mass transit In-plant Marine

Maximum line length and number of simultaneous dispense points also depends on the line diameter, fluid viscosity and required delivery

Light weight and effective high pressure delivery air operated pumps specially designed for use in mobile and portable greasing units.

Pumps are available with four different suction tube lengths, to fit all commercial grease drums: 12.5 - 20 kg (40 lb), 50 kg (120 lb) and 185 kg (400 lb). They include a height adjustable 2" BSP (M) bung adaptor.



FLUIDS HANDLED

- Grease up to NLGI-2.

MARKETS SERVED

- Agriculture.
- Service shops.
- Light industrial.

MODELS				
PART No.	APPLICATION	PUMP TUBE HEIGHT	TOTAL HEIGHT	WEIGHT
404 100	12.5 - 20 kg (40 lb) pails	410 mm	650 mm	3.5 kg
405 100	50 kg (120 lb) drums	510 mm	710 mm	3.7 kg
407 200	50 kg (120 lb) drums	725 mm	925 mm	4.3 kg
409 200	185 kg (400 lb) drums	920 mm	1,120 mm	4.8 kg

TECHNICAL DATA	
Pump pressure ratio	55:1
Air pressure operating range	1.5 to 10 bar (20 to 140 psi)
Air consumption ⁽¹⁾	165 NL/min (5.8 cfm)
Maximum fluid outlet pressure	550 bar (7,700 psi)
Air motor diameter	70 mm (2.75")
Air motor stroke	35 mm (1.4")
Delivery at 110 cpm	300 g/min (0.67 lb/min)
Maximum free flow delivery ⁽²⁾	540 g/min (1.2 lb/min)
Air inlet	1/4" NPSM (F)
Fluid outlet	1/4" NPSM (F)
Wetted and seal materials	Steel / NBR / PTFE
Noise level ⁽³⁾	92 dB

(1) Maximum air consumption with 6 bar air inlet pressure, NLGI-2 grease at 20 °C and 110 cpm.

(2) Maximum free delivery at 7 bar. NLGI-2 grease.

(3) Maximum noise level measured at 1 m from the pump, 7 bar air pressure and free delivery.

NLGI-2, 20 °C (68 °F) CAPACITY

DIMENSIONS (mm)				
MODEL	404 100	405 100	407 200	409 200
A	610	710	925	1,120
B	200	200	200	200
C	26	26	26	26
D	410	510	725	920
E	38	38	38	38

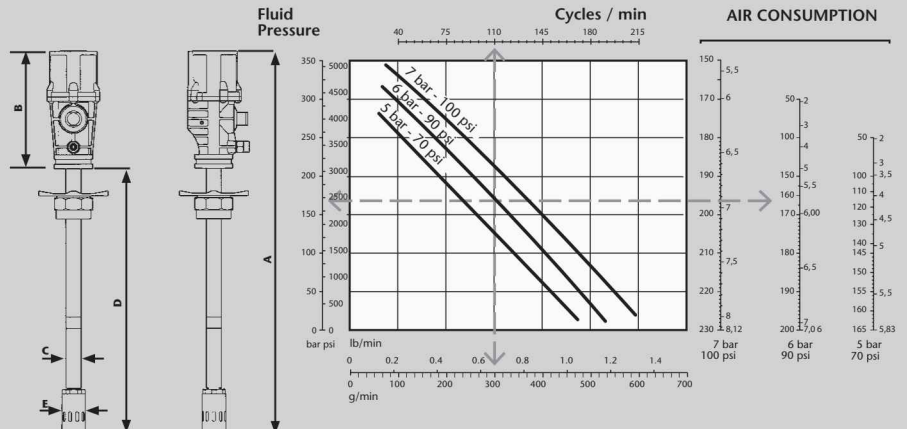

PUMPMASTER 3 - 55:1 RATIO GREASE PUMPS



424 172 - 424 152

482 200

425 150.002

428 243

02

GREASE PUMPS

Mobile and portable units to fit 18, 20, 50 and 185 kg drums.



Part No.	APPLICATION	PUMP	DRUM COVER	FOLLOWER PLATE	DELIVERY HOSE	GREASE GUN WITH Z-SWIVEL	TROLLEY
424 150	Mobile unit, 12.5 to 18 kg (1)	404 100	418 013	-	2 m x 1/4" 412 102	413 080	430 000
424 152	Mobile unit, 20 kg (1)	404 100	418 002	-	2 m x 1/4" 412 102	413 080	430 000
424 170	Portable unit, 12.5 to 18 kg (1)	404 100	418 013	-	2 m x 1/4" 412 102	413 080	-
424 170.800	Portable unit, 12.5 to 18 kg (1)	404 100	418 013	417 001	2 m x 1/4" 412 102	413 080	-
424 172	Portable unit, 20 kg (1)	404 100	418 002	-	2 m x 1/4" 412 102	413 080	-
424 172.710	Portable unit, 20 kg (1)	404 100	418 002	417 001	2 m x 1/4" 412 102	413 080	-
482 200	Mobile unit, 12.5 to 20 kg (2)	404 100	-	-	2 m x 1/4" 412 102	413 080	480 021
425 150	Mobile unit, 50 kg drum	407 200	418 004	-	3 m x 1/4" 412 103	413 080	431 000
425 150.002	Mobile unit, 50 kg drum	407 200	418 004	417 002	3 m x 1/4" 412 103	413 080	431 000
425 290	Mobile unit, 50 kg drum	407 200	418 004	-	2 m x 1/4" 412 102	413 080	430 000
482 500	Mobile unit, 50 kg drum (3)	407 200	-	-	3 m x 1/4" 412 103	413 080	480 050
428 243	Mobile unit, 185 kg drum	409 200	418 006	417 004	4 m x 1/4" 412 104	413 080	432 000
428 262	Stationary unit, 185 kg drum	409 200	418 006	417 004	4 m x 1/4" 412 104	413 080	-

(1) Includes carrying handle 741 602.

(2) Shielded unit. Includes base with 4 castors.

(3) Shielded unit. Includes base with 2 wheels and 2 castors.

Not included options:

239 000: 1/4" BSP (MM) connection adaptor.

240 500: Air filter and pressure regulator, 0-12 bar, 1/4" BSP (FF).

417 001: Follower plate 298 - 260 mm. For 12.5 and 18 kg pails.

417 002: Follower plate 370 - 330 mm. For 50 kg standard diameter drums.

417 003: Follower plate 405 - 360 mm. For 50 kg large diameter drums.

417 005: Follower plate 340 - 300 mm. For 20 kg pails.

411 100: In-line grease meter for grease control gun.



Drum covers. Very solid construction. With 2" BSP (F) bung opening.

PART No.	DRUM TYPE	DRUM EXTERNAL DIAMETER (MIN. - MAX.)
418 013	12.5 to 18 kg pails	265 - 310 mm
418 002	20 kg pails	285 - 330 mm
418 016	50 kg drums	350 - 395 mm
418 004	50 kg drums	360 - 405 mm
418 006	185 kg drums	565 - 610 mm

Follower plates eliminate air pockets and aid pump prime. Rubber flange minimizes waste. With handle for removing from empty drums.

PART No.	DRUM TYPE	DRUM EXTERNAL DIAMETER (MIN. - MAX.)
417 006	12.5 kg pails	190 - 260 mm
417 001	12.5 to 18 kg pails	260 - 298 mm
417 005	20 kg pails	300 - 340 mm
417 002	50 kg drums	330 - 370 mm
417 003	50 kg drums	360 - 405 mm
417 004	185 kg drums	550 - 590 mm

DRUM TROLLEYS



430 000



432 814

430 000 Trolley for 20 kg pails

Two wheel trolley with tubular frame for 20 and 50 kg drums.

431 000 Trolley for 50 and 20 kg drums

Four wheel trolley with tubular frame.

431 001 Trolley for 50 and 20 kg drums

Two wheel and two front rubber pads trolley with tubular frame.

480 050 Mobile protective drum cabinet, 50 kg

480 021 Mobile protective drum cabinet, 20 kg

432 000 Trolley for 185 kg drum

Two solid rubber wheels and one swivelling rubber wheel with brake. A hose reel and a pump can be, mounted using optional bracket.

360 134 Pump bracket

For mounting a short pump to trolley 432 000.

360 135 Hose reel bracket

For mounting a hose reel to trolley 432 000.



431 000



432 000

432 814 Heavy-Duty trolley for 185 kg drum

Two 260 mm front tires and one swivelling solid rubber wheel with brake. A hose reel can be, mounted using optional bracket.

360 113 Hose reel bracket

For mounting a hose reel to trolley 432 814.

HEAVY-DUTY PISTON PUMPS: THE HEART OF A LUBRICATION SYSTEM

Samoa Heavy-Duty pumps are designed to deliver through long distribution lines or to multiple dispensing points with simultaneous operation all kind of grease at continuous duty and high flow rates under extreme and intensive working conditions.

These double acting, high efficiency, air powered, positive displacement piston pumps provide the necessary confidence to offer solutions for moving fast the required volume of grease with the right pressure in very large distance applications.

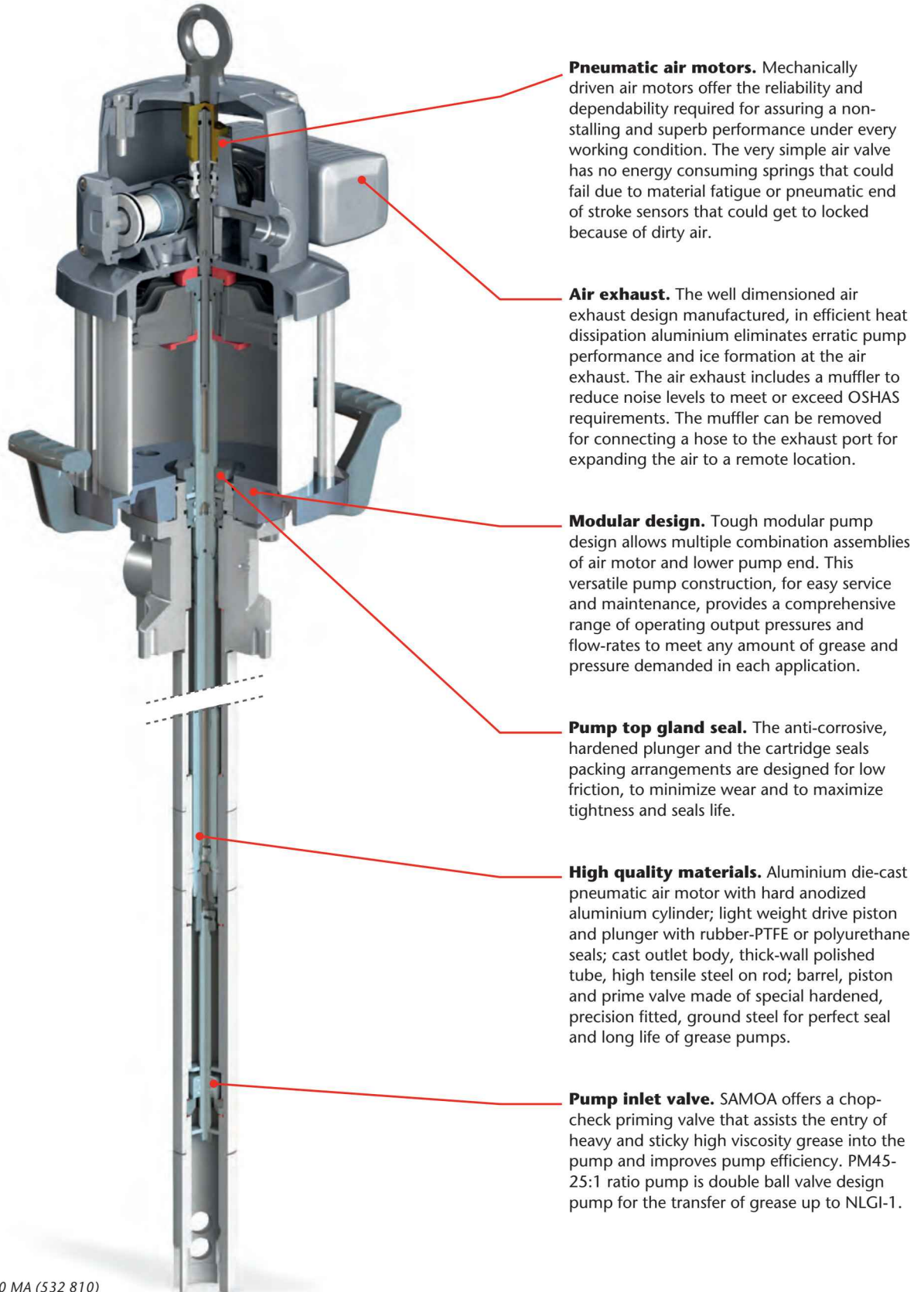

Pneumatic air motors. Mechanically driven air motors offer the reliability and dependability required for assuring a non-stalling and superb performance under every working condition. The very simple air valve has no energy consuming springs that could fail due to material fatigue or pneumatic end of stroke sensors that could get to locked because of dirty air.

Air exhaust. The well dimensioned air exhaust design manufactured, in efficient heat dissipation aluminium eliminates erratic pump performance and ice formation at the air exhaust. The air exhaust includes a muffler to reduce noise levels to meet or exceed OSHAS requirements. The muffler can be removed for connecting a hose to the exhaust port for expanding the air to a remote location.

Modular design. Tough modular pump design allows multiple combination assemblies of air motor and lower pump end. This versatile pump construction, for easy service and maintenance, provides a comprehensive range of operating output pressures and flow-rates to meet any amount of grease and pressure demanded in each application.

Pump top gland seal. The anti-corrosive, hardened plunger and the cartridge seals packing arrangements are designed for low friction, to minimize wear and to maximize tightness and seals life.

High quality materials. Aluminium die-cast pneumatic air motor with hard anodized aluminium cylinder; light weight drive piston and plunger with rubber-PTFE or polyurethane seals; cast outlet body, thick-wall polished tube, high tensile steel on rod; barrel, piston and prime valve made of special hardened, precision fitted, ground steel for perfect seal and long life of grease pumps.

Pump inlet valve. SAMOA offers a chop-check priming valve that assists the entry of heavy and sticky high viscosity grease into the pump and improves pump efficiency. PM45-25:1 ratio pump is double ball valve design pump for the transfer of grease up to NLGI-1.

PM60 - 80 MA (532 810)

Double acting pumps with high pressure and high volume delivery for use in lubrication systems. Pumps can be used with grease up to NLGI-2 consistency. These pumps can be used in medium length systems that include multiple outlets. Pumps are available for cover mount to 18 kg (35 lb), 50 kg (120 lb) and 185 kg (400 lb) open drums.



FLUIDS HANDLED

- Grease up to NLGI-2.

MARKETS SERVED

- Heavy-Duty service shops.
- Fleet service.
- Lube trucks.
- Mining and construction.
- Railroad and mass transit.
- In-plant.

MODELS				
PART No.	APPLICATION	PUMP TUBE HEIGHT	TOTAL HEIGHT	WEIGHT
530 610	185 kg (400 lb) drum	925 mm	1,212 mm	11 kg
530 620	50 kg (120 lb) drum	730 mm	1,017 mm	10 kg
530 630	12.5 - 20 kg (40 lb) pails	516 mm	803 mm	9 kg

TECHNICAL DATA	
Pump pressure ratio	60:1
Continuous duty flow rate (1)	900 g/min (2 lb/min)
Maximum free flow	2 kg/min (4.4 lb/min)
Air pressure operating range	2 to 10 bar (20 to 145 psi)
Maximum outlet pressure	600 bar (8,700 psi)
Air motor effective diameter	80 mm (3.15")
Air motor stroke	80 mm (3.15")
Air consumption (2)	450 NI/min (15.9 scfm)
Air inlet	3/8" BSP (F)
Fluid outlet	3/8" BSP (F)
Wetted and seal materials	Cast Iron / Hard chromed steel / Steel / UHMWPE / NBR / PTFE / Viton
Noise level (3)	80 dB

(1) Delivery at 80 cycles per minute.
 (2) Air consumption at 5 bar (70 psi) air pressure, NLGI-2 grease at 20 °C (68 °F) and 80 cpm.
 (3) Noise level measured at 1 m (3') from the pump, 7 bar (100 psi) air pressure and free delivery.

DIMENSIONS (mm)			
MODEL	530 610	530 620	530 630
A	1,212	1,017	803
B	287	287	287
C	35	35	35
D	925	730	516

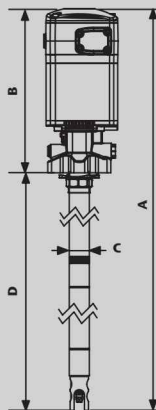
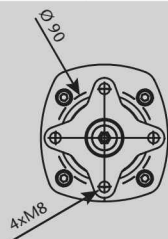

NLGI-2, 70 °F (21 °C) CAPACITY CURVE

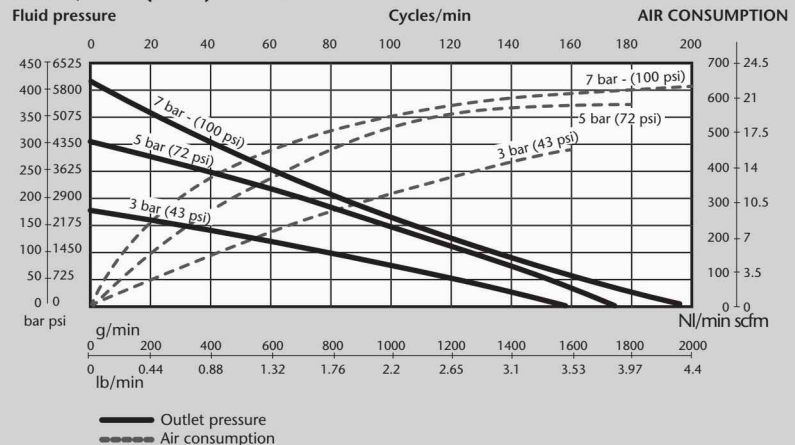

PUMPMASTER 35 - 60 :1 RATIO GREASE PUMPS



PUMPMASTER 35 - 60:1 RATIO PUMP KITS

534 610

02
GREASE PUMPS

534 620 PUMPMASTER 35 - 60:1 ratio pump kit for 50 kg drums







Includes 60:1 ratio pump for 50 kg drums 530 620 with drum cover for 50 kg drum 418 004, HD follower plate for 50 kg drum 417 014 and hose connection kit 534 600.

534 610 PUMPMASTER 35 - 60:1 ratio pump kit for 185 kg drums

Includes 60:1 ratio pump for 185 kg drums 530 610 with drum cover for 185 Kg drum 418 006, follower plate for 185 kg drums 417 012 and hose connection kit 534 600.



PUMPMASTER 35 - 60:1 RATIO PACKAGES FOR 185 KG, 50 KG DRUMS AND 20 & 18 KG PAILS

						
	PUMP AND HOSE REEL PACKAGE FOR 185 KG DRUMS	MOBILE PACKAGE FOR 185 KG DRUMS	MOBILE PACKAGE FOR 50 KG DRUMS ⁽¹⁾	MOBILE PACKAGE FOR 50 KG DRUMS	MOBILE PACKAGE FOR 20 KG PAILS ⁽²⁾	PORTABLE PACKAGE FOR 18 KG PAILS
PART No.	453 612	426 244	486 510	423 160	486 210	423 021
PUMP	530 610	530 610	530 620	530 620	530 630	530 630
DRUM COVER	418 006	418 006	-	418 013	-	418 013
FOLLOWER PLATE	417 012	417 004	-	-	-	417 001
HOSE CONNECTION KIT	534 600	-	-	-	-	-
GREASE GUN WITH Z-SWIVEL	413 080	413 080	413 080	413 080	413 080	413 080
DELIVERY HOSE	15 m Hose reel 504 351	4 m x 3/8" 412 394	3 m x 3/8" 412 393	3 m x 1/4" 412 393	2 m x 3/8" 412 390	2 m x 3/8" 412 390
DRUM TROLLEY	-	432 000	480 050 ⁽¹⁾	431 000	480 021 ⁽²⁾	-

(1) Shielded unit. Includes base with 2 wheels and 2 castors.

(2) Shielded unit. Includes base with 4 castors.

MOBILE EXTRUSION UNIT FOR 12-20 KG PAILS

424 062

Mobile unit specially designed for its use with hard to pump sticky and high viscosity greases (up to NLGI3). The pump's lower end is fixed to an inductor plate and the pump is mounted to a pneumatic piston that elevates the pump for replacing an empty pail. The pneumatic piston also acts when the pump is in use, pushing the inductor plate against the grease, aiding the pump prime, making possible to pump very high viscosity grease.

The unit includes a PM35 - 60:1 pressure ratio pump and it is mounted to a rolling base with 4 wheels, two of them with brake.

424 062 Mobile extrusion unit

Includes 3 m high pressure hose and a grease control gun with Z-swivel and hydraulic nozzle.

424 063 Mobile extrusion unit

Same as model 424 062 but with no outlet hose and grease control gun.



Not included options:

239 001: 1/4" BSP (M) - 3/8" BSP (M) connection adaptor.

240 500: Air filter and pressure regulator, 1/4" BSP (FF).

360 111: Hose reel pivoting bracket.

360 127: Control gun holder and drip tray.

417 001: Follower plate 298 - 260 mm. For 12.5 kg and 18 Kg pails.

417 002: Follower plate 370 - 330 mm. For 50 kg standard diameter drums.

417 003: Follower plate 405 - 360 mm. For 50 kg large diameter drums.

417 005: Follower pate 340 - 300 mm. For 20 Kg pail.

411 100: In line grease meter for grease control gun.

418 004 - 417 003

DRUM COVERS AND FOLLOWER PLATES



Drum covers. Very solid construction. With 2" BSP (F) bung opening.

PART No.	DRUM TYPE	DRUM EXTERNAL DIAMETER (MIN. - MAX.)
418 013	12,5 to 18 kg pails	265 - 310 mm
418 002	20 kg pails	285 - 330 mm
418 016	50 kg drums	350 - 395 mm
418 004	50 kg drums	360 - 405 mm
418 006	185 kg drums	565 - 610 mm

Follower plates eliminate air pockets and aid pump prime. Rubber flange minimizes waste. With handle for removing from empty drums.

PART No.	DRUM TYPE	DRUM EXTERNAL DIAMETER (MIN. - MAX.)
417 006	12,5 kg pails	190 - 260 mm
417 001	12,5 to 18 kg pails	260 - 298 mm
417 005	20 kg pails	300 - 340 mm
417 002	50 kg drums	330 - 370 mm
417 003	50 kg drums	360 - 405 mm
417 004	185 kg drums	550 - 590 mm

430 000 - 431 000 - 432 814 - 432 000

DRUM TROLLEYS



430 000 Trolley for 20 kg pails

Two wheel trolley with tubular frame for 20 and 50 kg drums.

431 000 Trolley for 50 and 20 kg drums

Four wheel trolley with tubular frame.

431 001 Trolley for 50 and 20 kg drums

Two wheel and two front rubber pads trolley with tubular frame.

480 050 Mobile protective drum cabinet, 50 kg

480 021 Mobile protective drum cabinet, 20 kg

432 000 Trolley for 185 kg drum

Two solid rubber wheels and one swivelling rubber wheel with brake. A hose reel and a pump can be, mounted using optional bracket.

360 134 Pump bracket

For mounting a short pump to trolley 432 000.

360 135 Hose reel bracket

For mounting a hose reel to trolley 432 000.

432 814 Heavy Duty trolley for 185 kg drum

Two 260 mm front tires and one swivelling solid rubber wheel with brake. A hose reel can be, mounted using optional bracket.

360 113 Hose reel bracket

For mounting a hose reel to trolley 432 814.

PUMPMASTER 45 - 25:1 RATIO GREASE PUMP



HEAVY-DUTY PRESSURE TRANSFER PUMP

531 210

02
GREASE PUMPS

Moderate pressure, high delivery double acting pumps for transfer of grease up to NLGI-2. Also recommended for use with low viscosity grease in centralized grease systems that do not require a very high pressure output and in large distribution systems of high viscosity oils.

Pumps are available with tube length to fit commercial 185 kg - 400 lb drums and they are available for cover mount to 185 kg - 400 lb open drums using a drum cover 418 017.

FLUIDS HANDLED

- Grease up to NLGI-2
- High viscosity oil.

MARKETS SERVED

- Lube trucks.
- Mining and construction.
- In-plant.



MODELS				
PART No.	APPLICATION	PUMP TUBE HEIGHT	TOTAL HEIGHT	WEIGHT
531 210	185 kg (400 lb) drum	855 mm	1,357 mm	24 kg

TECHNICAL DATA	
Pump pressure ratio	25:1
Continuous duty flow rate	6 kg/min (13.2 lb/min)
Maximum free flow	16 kg/min (35.3 lb/min)
Air pressure operating range	1.5 - 14 bar (20 - 200 psi)
Maximum outlet pressure	350 bar (5,000 psi)
Air motor effective diameter	115 mm (4.5")
Air motor stroke	100 mm (4")
Air consumption (1)	1,340 NI/min (47 cfm)
Air inlet	1/2" BSP (F)
Fluid outlet	1/2" BSP (F)
Wetted and seals materials	Cast Iron / Steel / Hard chromed steel / UHMWPE / NBR
Noise level (2)	80 dB

(1) Air consumption at 5 bar air pressure, NLGI-0 grease at 20 °C and 80 cpm.
 (2) Noise level measured at 1 m from the pump, 7 bar air pressure and free delivery.

NLGI-0, 21 °C (70 °F) CAPACITY

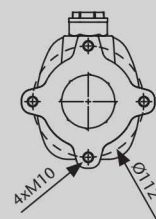
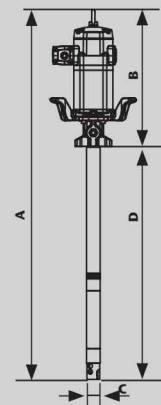
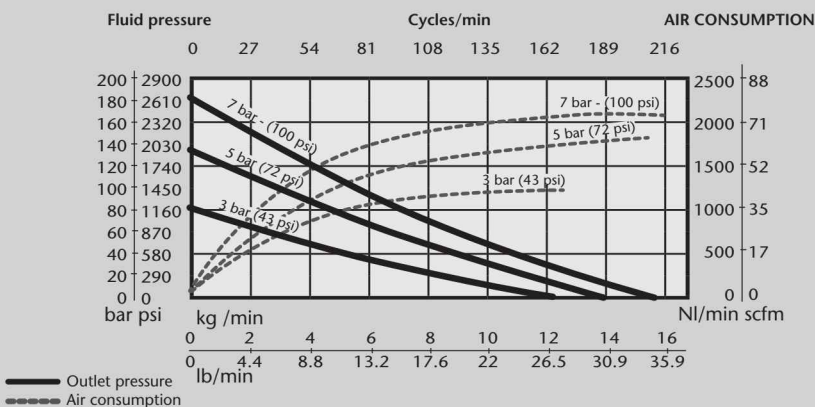

DIMENSIONS (mm)	
MODEL	531 210
A	1.357
B	502
C	50
D	855

High flow double acting pumps with high pressure delivery for use in lubrication systems that require a combination of high flow and pressure delivery. Pumps can be used with grease up to NLGI-2 viscosity. These pumps can be used in medium length systems that include simultaneous operation outlets.

Pumps are available for cover mount to 50 kg - 120 lb and 185 kg - 400 lb open drums and for horizontal and side mount on grease totes and bags.



FLUIDS HANDLED

- Grease up to NLGI-2.

MARKETS SERVED

- Heavy-Duty service shops.
- Fleets.
- Mining and construction.
- Railroad and mass transit.
- In-plant.
- Marine.

MODELS				
PART NO.	APPLICATION	PUMP TUBE HEIGHT	TOTAL HEIGHT	WEIGHT
531 410	185 kg (400 lb) drum	855 mm	1,357 mm	25 kg
531 420	50 kg (120 lb) drum	650 mm	1,152 mm	22 kg
531 430*	Bulk tote	490 mm	992 mm	26 kg

* Includes adaptor 753 110 to fit a 3" cam-lock connector for use in totes and grease bags.

TECHNICAL DATA	
Pump pressure ratio	40:1
Continuous duty flow rate	3.5 kg/min (7.5 lb/min)
Maximum free flow	11 kg/min (24.3 lb/min)
Air pressure operating range	1.5 - 14 bar (20 - 200 psi)
Maximum outlet pressure	560 bar (8,000 psi)
Air motor effective diameter	115 mm (4.5")
Air motor stroke	100 mm (4")
Air consumption (1)	750 NI/min (26.5 cfm)
Air inlet	1/2" BSP (F)
Fluid outlet	1/2" BSP (F)
Wetted and seals materials	Cast Iron / Steel / Hard chromed steel / UHMW PE / NBR / PTFE
Noise level (2)	80 dB

(1) Air consumption at 5 bar air pressure, NLGI-2 grease at 20 °C and 80 cpm.
 (2) Noise level measured at 1 m from the pump, 7 bar air pressure and free delivery.

DIMENSIONS (mm)			
MODEL	531 410	531 420	531 430*
A	1,357	1,152	992
B	502	502	502
C	50	50	50
D	855	650	490
E	-	-	410

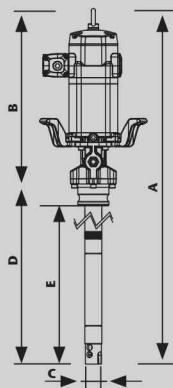
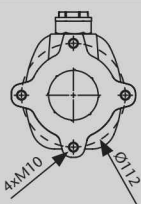

NLGI-2, 21 °C (70 °F) CAPACITY

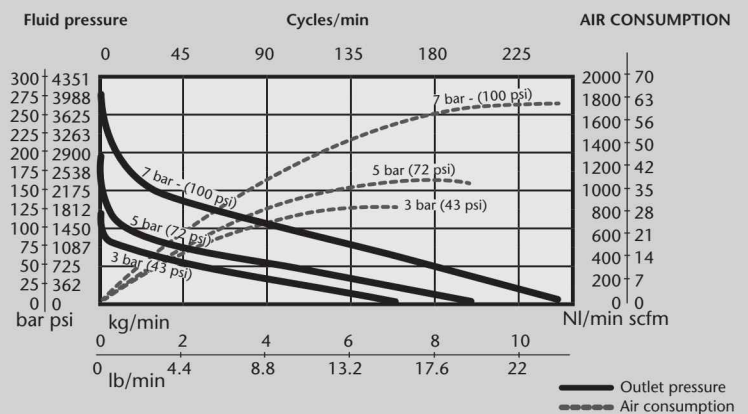

PUMPMASTER 45 - 70:1 RATIO GREASE PUMPS

HEAVY-DUTY HIGH PRESSURE PUMPS

531 710

02

GREASE PUMPS

High pressure double acting pump for use in applications that require extra pressure output or when cold temperatures a low air pressure could limit pump performance. Pumps can be used with grease up to NLGI-2 viscosity. These pumps can be used in large distribution systems that include simultaneous operation outlets.

Pumps are available for cover mount to 50 kg - 120 lb and 185 kg - 400 lb open drum and for horizontal and side mount on grease totes and bags.

FLUIDS HANDLED

- Grease up to NLGI-2.

MARKETS SERVED

- Heavy-Duty service shops.
- Fleets.
- Lube trucks.
- Mining and construction.
- Rail road and mass transit.
- In-plant.
- Marine.



MODELS				
PART NO.	APPLICATION	PUMP TUBE HEIGHT	TOTAL HEIGHT	WEIGHT
531 710	185 kg (400 lb) drum	855 mm	1,357 mm	25 kg
531 720	50 kg (120 lb) drum	650 mm	1,152 mm	22 kg
531 730*	Bulk tote	490 mm	992 mm	21 kg

* Includes adaptor 753 110 to fit a 3" cam-lock connector for use in totes and grease bags.

TECHNICAL DATA	
Pump pressure ratio	70:1
Continuous duty flow rate	2 kg/min (4.5 lb/min)
Maximum free flow	7.5 kg/min (16.5 lb/min)
Air pressure operating range	1.5 - 7 bar (20 - 100 psi)
Maximum outlet pressure	490 bar (7,000 psi)
Air motor effective diameter	115 mm (4.5")
Air motor stroke	100 mm (4")
Air consumption ⁽¹⁾	925 NI/min (32.6 cfm)
Air inlet	1/2" BSP (F)
Fluid outlet	1/2" BSP (F)
Wetted and seals materials	Cast Iron / Steel / Hard chromed steel / UHMW PE / NBR / PTFE
Noise level ⁽²⁾	80 dB

(1) Air consumption at 5 bar air pressure, NLGI-2 grease at 20 °C and and 80 cpm.

(2) Noise level measured at 1 m from the pump, 7 bar air pressure and free delivery.

NLGI-2, 21 °C (70 °F) CAPACITY

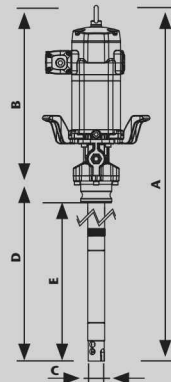
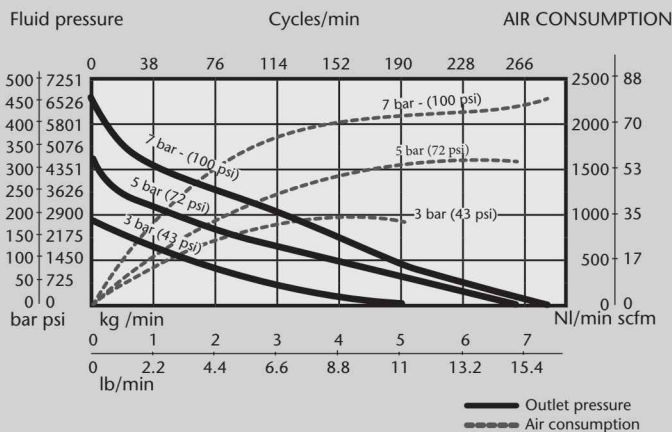

DIMENSIONS (mm)			
MODEL	531 710	531 720	531 730*
A	1,357	1,152	992
B	502	502	502
C	50	50	50
D	855	650	490
E	-	-	410

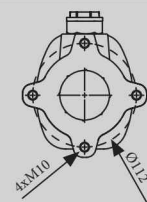

Moderate pressure, very high volume double acting grease pump for use in transfer applications. These pumps can be used with all type of grease up to NLGI-2.

Pumps are available for horizontal mounting on grease totes and grease bags and they include an adaptor to fit a 3" Cam-Lock coupler. They can be used with 185 kg - 400 lb drums when mounted to air pneumatic inductor (see "Grease pump kits" section in this chapter.)



FLUIDS HANDLED

- Grease up to NLGI-2.

MARKETS SERVED

- Mining and construction.
- In-plant grease transfer.
- Rail road and mass transit.

MODELS				
PART NO.	APPLICATION	PUMP TUBE HEIGHT	TOTAL HEIGHT	WEIGHT
532 130*	Bulk tote	226 mm	742 mm	19 kg

* Includes adaptor 753 110 to fit a 3" cam-lock connector for use in totes and grease bags.

TECHNICAL DATA	
Pump pressure ratio	12:1
Continuous duty flow rate	15 kg/min (33 lb/min)
Maximum free flow	40 kg/min (88 lb/min)
Air pressure operating range	1.5 - 7 bar (20 - 100 psi)
Maximum outlet pressure	84 bar (1,200 psi)
Air motor effective diameter	150 mm (6")
Air motor stroke	100 mm (4")
Air consumption ⁽¹⁾	1,100 NI/min (39 cfm)
Air inlet	1/2" BSP (F)
Fluid outlet	1" BSP (F)
Wetted and seals materials	Cast Iron / Steel / Hard chromed steel / UHMWPE / NBR / PTFE / Polyurethane
Noise level ⁽²⁾	80 dB

(1) Air consumption at 5 bar air pressure, NLGI-2 grease at 20 °C and 60 cpm.
 (2) Noise level measured at 1 m from the pump, 7 bar air pressure and free delivery.

DIMENSIONS (mm)	
MODEL	532 130
A	742
B	516
C	70
D	226
E	146

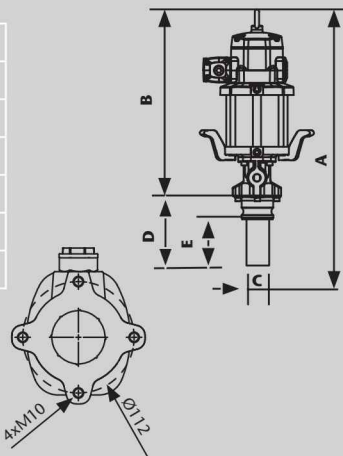

NLGI-2, 21 °C (70 °F) CAPACITY

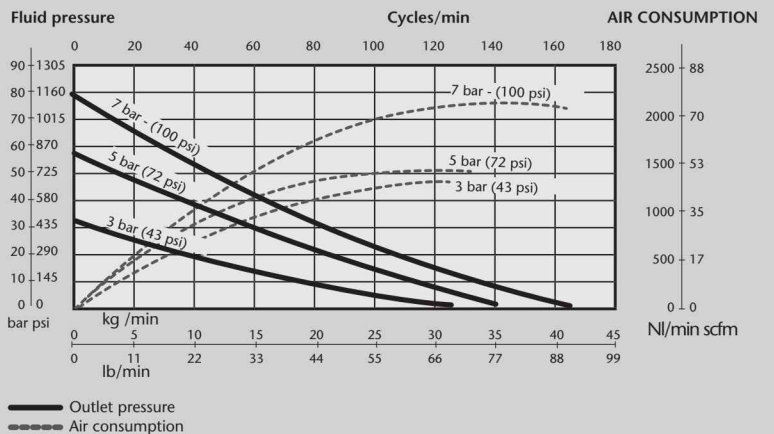

PUMPMASTER 60 - 80:1 RATIO GREASE PUMPS

HEAVY-DUTY HIGH PERFORMANCE PUMPS

532 810

02

GREASE PUMPS

Very high pressure and high volume delivery double acting pump for use in applications that require extra pressure and volume output and where cold temperatures or low air pressure could limit pump performance. Pumps can be used with grease up to NLGI-2 viscosity. These pumps can be used in large distribution systems that include simultaneous operation outlets. Pumps are available for cover mount to 50 kg -120 lb and 185 kg - 400 lb open drum and for side mount on grease totes.

FLUIDS HANDLED

- Grease up to NLGI-2.

MARKETS SERVED

- Mining and construction.
- In-plant.
- Railroad and mass transit.
- Lube trucks.
- Fleets.



MODELS				
PART No.	APPLICATION	PUMP TUBE HEIGHT	TOTAL HEIGHT	WEIGHT
532 810	185 kg (400 lb) drum	855 mm	1,371 mm	27 kg
532 820	50 kg (120 lb) drum	650 mm	1,166 mm	24 kg

TECHNICAL DATA	
Pump pressure ratio	80:1
Continuous duty flow rate	2.5 kg/min (5.5 lb/min)
Maximum free flow	8 kg/min (17.6 lb/min)
Air pressure operating range	1.5 - 7 bar (20 - 100 psi)
Maximum outlet pressure	560 bar (8,000 psi)
Air motor effective diameter	150 mm (6")
Air motor stroke	100 mm (4")
Air consumption (1)	1,000 NI/min (35 cfm)
Air inlet	1/2" BSP (F)
Fluid outlet	1/2" BSP (F)
Wetted and seals materials	Cast Iron / Steel / Hard chromed steel / UHMW PE / NBR / PTFE
Noise level (2)	80 dB

(1) Air consumption at 5 bar air pressure, NLGI-2 grease at 20 °C and 60 cpm.
 (2) Noise level measured at 1 m from the pump, 7 bar air pressure and free delivery.

NLGI-2, 21 °C (70 °F) CAPACITY

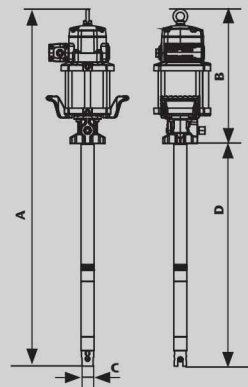
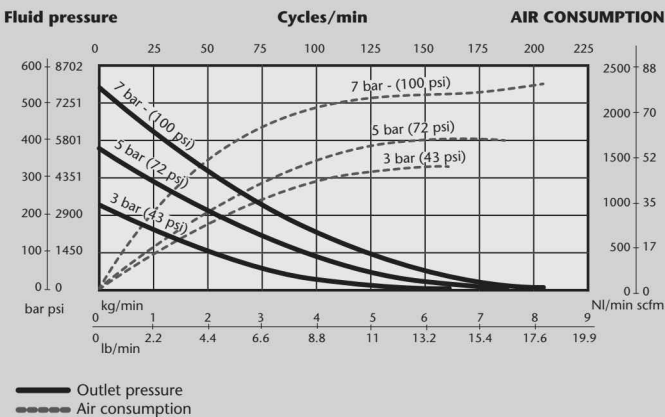

DIMENSIONS (mm)		
MODEL	532 810	532 820
A	1,371	1,166
B	516	516
C	50	50
D	855	650

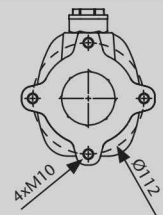

PUMPMASTER 45 & 60 INSTALLATION KITS

02

GREASE PUMPS

534 710

PUMPMASTER 45 INSTALLATION KITS

PM45 pump kits for 50 kg and 185 kg drums, totes and grease bins.



	KIT PART No.	PUMP	RATIO	COVER	FOLLOWER PLATE	CONNECTION KIT	CAMLOCK FEMALE	CAMLOCK MALE
50 KG DRUM MOUNTED PUMP KIT	534 420	531 420	40:1	418 017	(1)	534 103	-	-
	534 720	531 720	70:1	418 017	(1)	534 103	-	-
185 KG DRUM MOUNTED PUMP KIT	534 410	531 410	40:1	418 026	417 009	534 103	-	-
	534 710	531 710	70:1	418 026	417 009	534 103	-	-
	534 210	531 210	25:1	418 026	417 009	534 103	-	-
TANK SIDE MOUNTED PUMP KIT	534 240	531 210	25:1	-	-	534 103	950 358	753 110
	534 440	531 410	40:1	-	-	534 103	950 358	753 110
	534 740	531 710	70:1	-	-	534 103	950 358	753 110
TANK HORIZONTAL MOUNTED PUMP KIT	534 441	531 430	40:1	-	-	534 103	950 358	(2)
	534 741	531 730	70:1	-	-	534 103	950 358	(2)

(1) Use follower plate 417 010 or 417 011 as required. Follower plate not included.
 (2) Included with pump.

SAMOA recommends using an air filter and pressure regulator at the pump air inlet and a high pressure needle valve between the grease delivery hose and the grease distribution line.

534 141

PUMPMASTER 60 INSTALLATION KITS

PM60 pump kits for 50 kg and 185 kg drums, totes and grease bins.



	KIT PART No.	PUMP	RATIO	COVER	FOLLOWER PLATE	CONNECTION KIT	CAMLOCK FEMALE	CAMLOCK MALE
50 KG DRUM MOUNTED PUMP KIT	534 820	532 820	80:1	418 017	(1)	534 103	-	-
185 KG DRUM MOUNTED PUMP KIT	534 810	532 810	80:1	418 026	417 009	534 103	-	-
TANK SIDE MOUNTED PUMP KIT	534 840	532 810	80:1	-	-	534 103	950 358	753 110
TANK HORIZONTAL MOUNTED PUMP KIT	534 141	532 130	12:1	-	-	539 009	950 358	(2)

(1) Use follower plate 417 010 or 417 011 as required. Follower plate not included.
 (2) Included with pump.

SAMOA recommends using an air filter and pressure regulator at the pump air inlet and a high pressure needle valve between the grease delivery hose and the grease distribution line.

391 022

PUMP HOIST



DRUM MOUNTED PUMP

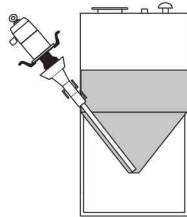

TANK SIDE MOUNT PUMP

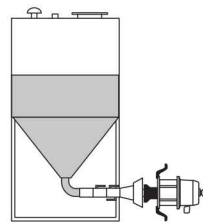

TANK HORIZONTAL MOUNT PUMP

391 022 Pump Hoist

Maximum utility air operated hoist lifts and lowers pumps, making drum changes easier, faster and safer. Hoist arm adjusts to fit different pump heights and swings a full 360°, serving one or more pumps. It can be used with 185 kg - 400 lb and 50 kg - 120 lb drums. Maximum height raised: 2.630 mm. Minimum height lowered: 1.630 mm.

PUMPMASTER 45 and PUMPMASTER 60 grease pumps mounted onto an air operated inductor plate for use with high viscosity, hard to pump greases directly from 185 kg drum. When the double lip inductor plate is attached to the lower end of the pump tube, it exerts pneumatic, weight and atmospheric pressure on the material forcing pump priming. The inductor plate also serves as protection against contaminants and eliminates material waste. The inductor system includes guide rods, drum retaining mechanism and a control box with the following features:

- On/ Off control of the pump.
- Up / Down control of the ram for easy drum exchange.
- Two independent air pressure regulators, one for the pump and the other for the power ram cylinders.
- Pump / Ram independent air pressure gauge.
- Empty drum shut-off safety feature.
- Automatic Vacuum release.

534 421, PM45 - 40:1 pump system with air operated double post inductor for 185 kg drums

Includes pump 531 420.

534 721, PM45 - 70:1 pump system with air operated double post inductor for 185 kg drums

Includes pump 531 720.

534 121, PM60 - 12:1 pump system with air operated double post inductor for 185 kg drums

Includes pump 532 130.

534 821, PM60 - 80:1 pump system with air operated double post inductor for 185 kg drums

Includes pump 532 820.



Dimensions in mm

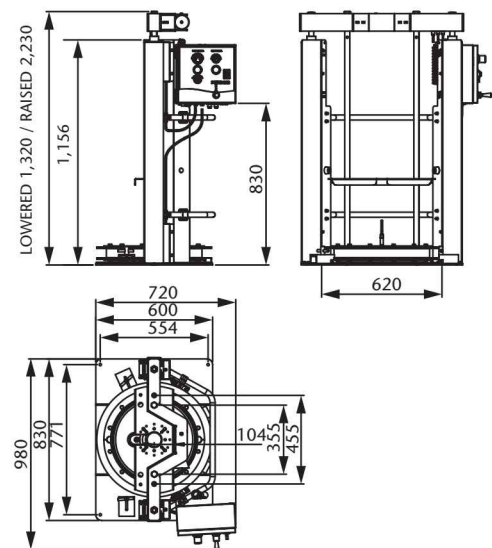

PUMPMASTER 35, 45 AND 60 GREASE PUMP KITS

PUMP SYSTEMS WITH PNEUMATIC PUMP HOIST AND GRAVITY INDUCTOR FOR 50 AND 185 KG DRUMS

02

534 611 - 534 811

GREASE PUMPS



PUMPMASTER 35, 45 and 60 grease pumps mounted onto a gravity fed follower plate and an air operated pump hoist for use with 185 kg drums.

The air operated pump hoist lifts and lowers the pump, making drums changes easier, faster and safer. The pump lower end is rigidly fixed to a follower plate with a single rubber lip. The weight of the pump, pump bracket and follower plate plus the atmospheric pressure push the assembly against the fluid eliminating channelling and air pocket, keeping lubricant free from contaminants, minimizing waste and aiding pump priming.

534 611, PM35 - 60:1 pump system with pump hoist and gravity follower plate for 185 kg drums

Includes pump 530 610 and hose connection kit Part No. 534 612.

534 621, PM35 - 60:1 pump system with pump hoist and gravity follower plate for 50 kg drums

Includes pump 530 620 and hose connection kit Part No. 534 622.

534 411, PM45 - 40:1 pump system with pump hoist and gravity follower plate for 185 kg drums

Includes pump 531 410 and hose connection kit Part No. 534 414.

534 422, PM45 - 40:1 pump system with pump hoist and gravity follower plate for 50 kg drums

Includes pump 531 420 and hose connection kit Part No. 534 423.

534 711, PM45 - 70:1 pump system with pump hoist and gravity follower plate for 185 kg drums

Includes pump 531 710 and hose connection kit Part No. 534 414.

534 722, PM45 - 70:1 pump system with pump hoist and gravity follower plate for 50 kg drums

Includes pump 531 720 and hose connection kit Part No. 534 423.

534 811, PM60 - 80:1 pump system with pump hoist and gravity follower plate for 185 kg drums

Includes pump 532 810 and hose connection kit Part No. 534 414.

534 822, PM60 - 80:1 pump system with pump hoist and gravity follower plate for 50 kg drums

Includes pump 532 820 and hose connection kit Part No. 534 423.

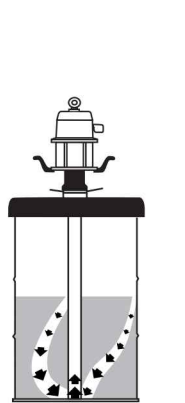
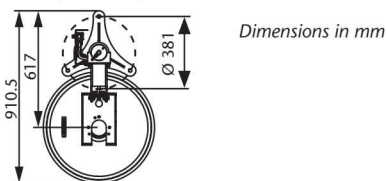
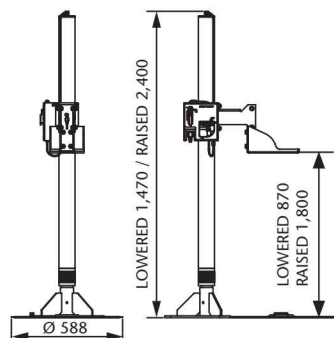

NO INDUCTOR. AIR POCKETS AND CHANNELS CAN BE FORMED.

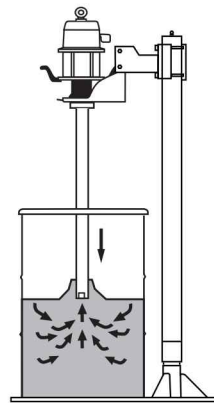

WITH INDUCTOR PLATE. PUMP IS PERMANENTLY PRIMED.

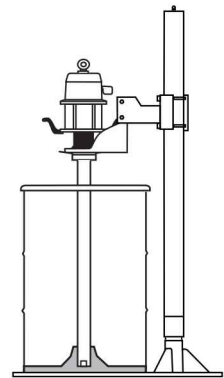

INDUCTOR PLATES AID TO MINIMIZE WASTE LEFT IN THE DRUM.

GREASE PUMP ACCESSORIES

418 026 - 418 017



HD DRUM COVERS

For PUMPMASTER 35, 45 and 60 pumps
Covers are made from heavy steel gauge to withstand hard usage. Cover flange provides rigidity and maintains solid position on drum. Grease pump mounts in centre of cover with four screws.

PART No.	APPLICATION	MAX. - MIN. DRUM DIAMETER
418 026*	185 kg - 400 lb	620 - 580 mm
418 017*	50 kg - 120 lb	395 - 350 mm

*Drum cover adaptor required for PM35 pump. Part No. 360 133.

417 009 - 417 010



HD FOLLOWER PLATES

For PUMPMASTER 35, 45 and 60 pumps
Follower plates eliminate channelling and air pockets, keep lubricant free from contaminants, remove all grease from the drum and aid pump prime.

PART No.	APPLICATION	MAX. - MIN. DRUM Ø
417 009	185 kg (PM45&60)	590 - 550 mm
417 010	50 kg (PM45&60)	405 - 360 mm
417 011	50 kg (PM45&60)	370 - 330 mm
417 012	185 kg PM35	590 - 550 mm
417 013	50 kg PM35	405 - 360 mm
417 014	50 kg PM35	370 - 330 mm

741 604



Pump, follower plate, drum cover and drum are not included.

HOLD DOWN KITS

Allow to fix a 185 kg or a 50 kg drum to a lube truck bed when used together with drum covers 418 026 and 418 017.

741 604 Hold down kit for 185 kg - 400 lb drums
For use with drum cover 418 026.
741 605 Hold down kit for 50 kg - 129 lb drums
For use with drum cover 418 017.

AIR AND GREASE CONNECTION KITS

FOR PM35 PUMPS

534 600

Includes 1 m x 3/8" air hose (PN 247 710) with 3/8" - 1/2" BSP (MM) connection threads, quick air coupler 251 438, air nipple 255 338, 1.5 m x 3/8" high pressure grease hose (412 392) with 3/8"-1/2" BSP (MM) connection threads

FOR PM45 AND PM60 PUMPS⁽¹⁾

534 103

Includes 1.8 m x 1/2" air hose (248 018) with 1/2" BSP (MM) connection threads, elbow 239 352, quick air coupler 251 412, air nipple 255 312, 1.8 m x 1/2" high pressure grease hose (412 202) with 1/2" BSP (MM) connection threads and swivel elbow (945 736) with 1/2" BSP (M/F) threads

(1) Hook up kits are valid for all PM45 and PM60 grease pumps except PM60 12:1 pressure ratio pump.

AIR ACCESSORIES

AIR ACCESSORIES	1/4" CONNECTION THREADS 1/4" BSP (FF)	1/2" CONNECTION THREADS 1/2" BSP (FF) WITH ONE 1/2" BSP (M) 3/8" BSP (F) ADAPTOR	3/4" CONNECTION THREADS 3/4" BSP (FF)
AIR PRESSURE REGULATOR 0-12 BAR	240 200	241 201	242 202
COMBINED AIR FILTER AND PRESSURE REGULATOR	240 500	241 501	242 302 (Filter only)
AIR LUBRICATOR	240 400	241 401	242 402



240 200



241 501



242 202

753 110 - 950 358



CAM-LOCK ADAPTORS

Allow to fix a pump horizontally or vertically to grease bags, totes and other type of containers.

753 110 Male Cam-Lock adaptor
Fixes to the bottom end of the grease pump body. Fits any standard 3" female Cam-Lock connector.

950 358 Female Cam-Lock connector
Connection thread 3" BSP (F).

LOW AND MEDIUM PRESSURE VALVES

950 305	1/4" BSP (FF), 65 bar quarter turn valve
950 320	3/8" BSP (FF), 65 bar quarter turn valve
950 300	1/2" BSP (FF), 65 bar quarter turn valve
HIGH PRESSURE VALVES	
950 304	1/2" BSP (FF), 500 bar quarter turn valve
950 328	3/4" BSP (FF), 400 bar quarter turn valve
950 329	1" BSP (FF), 350 bar quarter turn valve

AIR LINE SHUTOFF VALVES

950 318	Air valve, 3/8" BSP (FF)
950 319	Air valve, 1/2" BSP (FF)

950 304



DRUM COVER ADAPTOR



360 133 Drum Cover adaptor
Allows to mount a bung fixed PM35 pump to a flange mount covers 418 026 and 418 017.

412 103

GREASE HOSES



Manufactured in NBR with a high density steel reinforcement braid. With two swaged nuts and male-male adaptors on both ends.

412 101, 1 m x 1/4". Working pressure: 400 bar. Connection threads: 1/4" BSP (MM).

412 190, 1.5 m x 1/4". Working pressure: 400 bar. Connection threads: 1/4" BSP (MM).

412 102, 2 m x 1/4". Working pressure: 400 bar. Connection threads: 1/4" BSP (MM).

412 103, 3 m x 1/4". Working pressure: 400 bar. Connection threads: 1/4" BSP (MM).

412 104, 4 m x 1/4". Working pressure: 400 bar. Connection threads: 1/4" BSP (MM).

412 391, 1.5 m x 3/8". Working pressure: 330 bar. Connection threads: 1/4" - 3/8" BSP (MM).

412 392, 1.5 m x 3/8". Working pressure: 330 bar. Connection threads: 3/8" BSP (MM).

412 390, 2 m x 3/8". Working pressure: 330 bar. Connection threads: 1/4" - 3/8" BSP (MM).

412 393, 3 m x 3/8". Working pressure: 330 bar. Connection threads: 1/4" - 3/8" BSP (MM).

412 394, 4 m x 3/8". Working pressure: 330 bar. Connection threads: 1/4" - 3/8" BSP (MM).

412 202, 1.8 m x 1/2". Working pressure: 275 bar. Connection threads: 1/2" BSP (MM).

412 203, 3 m x 1/2". Working pressure: 275 bar. Connection threads: 1/2" BSP (MM).

GREASE PUMP MOUNTING ACCESSORIES QUICK REFERENCE CHART

PUMP	PUMPMASTER 3	PUMPMASTER 35	PUMPMASTER 45			PUMPMASTER 60 ⁽¹⁾	
RATIO	55:1	60:1	25:1	40:1	70:1	12:1	80:1
BUNG ADAPTOR	410 000	609 106	(2)	(2)	(2)	(2)	(2)
CONNECTION HOSE KIT	412 910	534 600	534 103	534 103	534 103	539 009	534 103
DRUM COVER 185 KG	418 006	418 006	418 026	418 026	418 026	N/A	418 026
DRUM COVER 50 KG	418 004	418 004	N/A	418 017	418 017	N/A	418 017
HD FOLLOWER PLATE 185 KG	417 004	417 012	417 009	417 009	417 009	N/A	417 009
HD FOLLOWER PLATE 50 KG	417 002	417 014	N/A	417 011	417 011	N/A	417 011
CAM-LOCK ADAPTOR	N/A	N/A	N/A	753 110 ⁽³⁾	753 110 ⁽³⁾	753 110 ⁽³⁾	753 110 ⁽⁴⁾
CAM-LOCK CONNECTOR	N/A	N/A	N/A	950 358	950 358	950 358	N/A
AIR REGULATOR WITH GAUGE	240 200	241 201	241 201	241 201	241 201	241 201	241 201
AIR FILTER LUBRICATOR	240 500	241 501	241 501	241 501	241 501	241 501	241 501
FRL	240 000	241 001	241 001	241 001	241 001	241 001	241 001
AIRLINE SHUTOFF VALVE	950 321	950 319	950 319	950 319	950 319	950 319	950 319
FLUID SHUTOFF VALVE	950 304	950 304	950 328	950 304	950 304	950 328	950 304
AIR QUICK COUPLER	253 114	255 338	251 412	251 412	251 412	251 412	251 412
AIR QUICK CONNECTOR	259 014	251 438	255 312	255 312	255 312	255 312	255 312
AIR CONNECTION ACCESSORIES I.D.	1/4" - 6 mm	3/8" - 9.5 mm	1/2" - 12.5 mm	1/2" - 12.5 mm	1/2" - 12.5 mm	1/2" - 12.5 mm	1/2" - 12.5 mm

(1) PM60, 12:1 pump is only available for horizontal mount on tanks, totes and grease bags.

(2) Flange mounted pumps. No bung adaptor for fixing a pump to a cover.

(3) Included in short pumps for horizontal mount on tanks, totes and grease bags. Required for vertical mount on grease tanks (long pumps).

(4) For vertical mount on grease tanks only (long pumps).

INNOVATIVE CENTRAL FLOW TECHNOLOGY	54
DIRECTFLO® PUMP RANGE COMPARATIVE CHART	55
AIR OPERATED DIAPHRAGM PUMPS PLASTIC PUMPS	56
AIR OPERATED DIAPHRAGM PUMPS METAL PUMPS	57
FOUR-WAY EVACUATION VALVE AND AIR OPERATED DIAPHRAGM PUMPS - MIX PUMPS	58
AIR OPERATED DIAPHRAGM PUMP KITS	59
DIAPHRAGM PUMPS ACCESSORIES	61
AIR OPERATED PISTON PUMPS FOR FLUIDS	62

